

discover  
the power of  
**Dauer**  
MANUFACTURING®



PRESENTING

**JARVIS**  
**300W SMART WI-FI TRANSFORMER**

# TABLE OF CONTENTS

SPECIFICATIONS of JARVIS ..... 1

SAFETY INFORMATION..... 2

PRE-INSTALLATION HARDWARE..... 3

INSTALLATION..... 4

CLOUD-BASED DIAGRAM..... 5

CHAPTER 1: PROGRAMMING JARVIS 300W SMART TRANSFORMER ..... 6-11

CHAPTER 2: NAME YOUR ZONES..... 12

CHAPTER 3: PROGRAMMING ASTRONOMICAL TIMERS ..... 13-14

CHAPTER 4: SCHEDULING YOUR ZONES ..... 15-17

CHAPTER 5: HOW TO SHARE & ACCEPT YOUR SMART TRANSFORMER ..... 18-20

CHAPTER 5A: HOW TO UNSHARE YOUR SMART TRANSFORMER..... 21-22

-31CHAPTER 6: TRANSFORMER POWER CONSUMPTION ..... 23

CHAPTER 7: DEVICE INFO & RUNNING SYSTEMS DIAGNOSTICS ..... 24-25

CHAPTER 8: SET UP BLUETOOTH® CONTROL MODE ..... 26

CHAPTER 9: ALEXA® SET UP ..... 27-29

CHAPTER 10: GIVING ADMINISTRATOR ACCESS ..... 30-33

# JARVIS 300W Smart Transformer

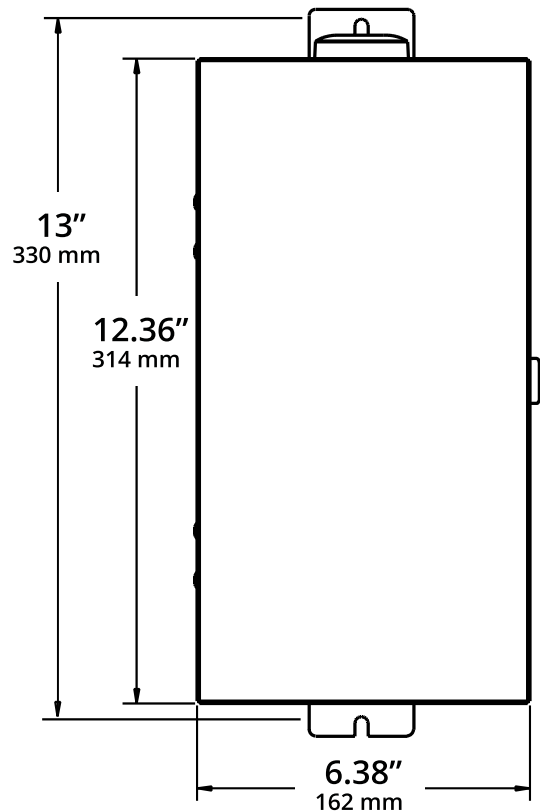

## SPECIFICATIONS

INPUT: 120VAC 60Hz 2.5A  
OUTPUT: 15VAC  
MAX RATING: 300VA max  
MODEL: JARVIS 300W Smart Transformer  
PRODUCT CODE: 490545  
3 channels, single channel can handle full 300W Caution - DO NOT exceed 300W total output, includes lamp load+output wire loss

## SYSTEM

WIRELESS TYPE: 2.4GHz IEEE802.11 B/G/N  
WI-FI RANGE: 80FT (FREE AREA)  
APP: SMART LIFE  
IOS: 8.0 or HIGHER  
ANDROID: 4.1 or HIGHER



Download The Dauer App

## SAFETY INFORMATION

1. Do not install within 10 feet (3m) of a pool, spa, or fountain.
2. This transformer is suitable for mounting within 12 in. to 48 in. (0.3m to 1.2m) of the ground.
3. For use with a low-voltage outdoor landscape lighting system.
4. There are no serviceable parts inside the power supply unit. DO NOT DISASSEMBLE.
5. Do not submerge transformer.
6. Do not connect two or more transformers in parallel.
7. Do not use with a dimmer.
8. Plug the power supply unit directly into a GFCI wet location outlet.
9. Do not use an extension cord.
10. The maximum output of this transformer is equal to or less than 300 watts. Do not overload the transformer. Be sure that the total cumulative wattage of all 12-15 volt fixtures connected to the transformer is equal to or less than 300 watts. Total bulb wattage must not exceed a maximum of 300 watts.
11. For best performance, and to limit operation of the automatic thermal protector, do not install where air flow around the unit is overly restricted.
12. For supply connections, use wire rated for at least 60°C.
13. Keep enclosure cover closed.
14. Suitable for use with submersible luminaires or submersible pumps or equivalent.



**WARNING: Risk of Electric Shock.** Install power unit 5 feet (1.5m) or more from a pool, spa, or fountain. Where the power unit is installed (a) indoors within 10 feet (3.0m) of a pool, spa, or fountain or (b) outdoors, connect power unit to a receptacle protected by a GFCI.



**WARNING:** For outdoor installations use UL-listed underground low energy circuit cable or SPT-3 or SPT-2W. Failure to use at least 16-gauge minimum cable or install it as directed in these instructions may result in risk of fire or electric shock. Using large cable will ensure maximum light output.



**WARNING:** Changes or modifications to this unit not expressly approved by the party responsible for compliance could void the user's authority to operate the equipment.



**IMPORTANT:** This landscape light system must be installed in accordance with all local codes and ordinances. If you are experiencing problems, contact a qualified electrician.

# PRE-INSTALLATION

## Hardware Included



**NOTE:** Hardware not shown to actual size.

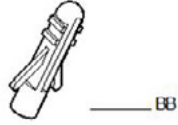

Part	Description	Quantity
AA	4.8X30 Screw	2
BB	Wall Anchor	2

# INSTALLATION

## 1. Preparing the cable

- ◇ Use caution when splitting to avoid exposing copper wire.
- ◇ Remove 1/2 in. of insulation from both wires and twist the ends. Refer to the strip-length guide on the transformer (A).

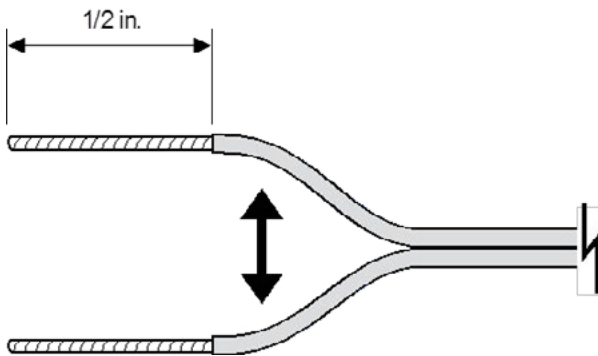

## 3. Layout garden light

- ◇ Lay the fixtures (not included) in their desired locations. Be sure they do not exceed the 300-watt rating of the transformer.
- ◇ Route the low voltage cable to the fixtures. If there is extra cable, coil the cable after the last fixture.

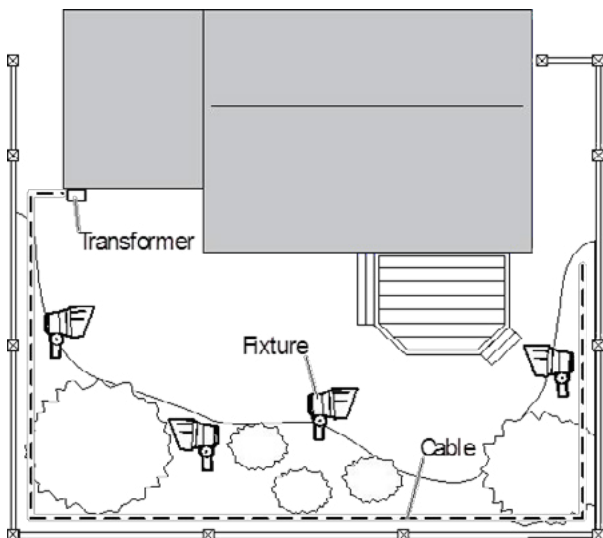

## 2. Connect the cable

Lay the transformer on a flat, stable surface and insert the stripped end of one wire under the terminal clamping plat COM1 CH1, COM2 CH2, COM3 CH3, then tighten the screw.

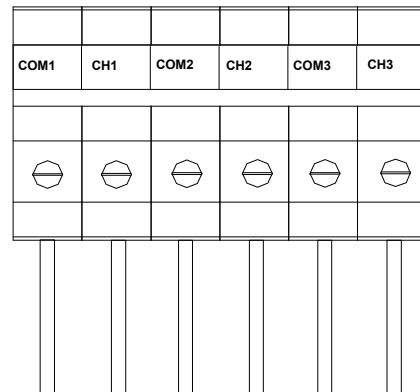

## 4. Mounting the transformer

Turn the transformer on. Attach your fixtures to the cable using cable connectors as shown.

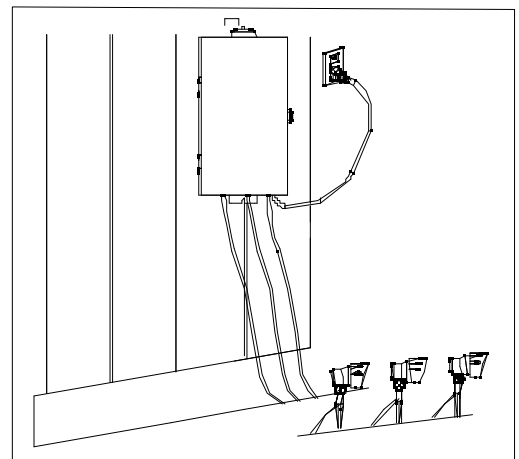

# JARVIS 300W Smart Transformer DIAGRAM

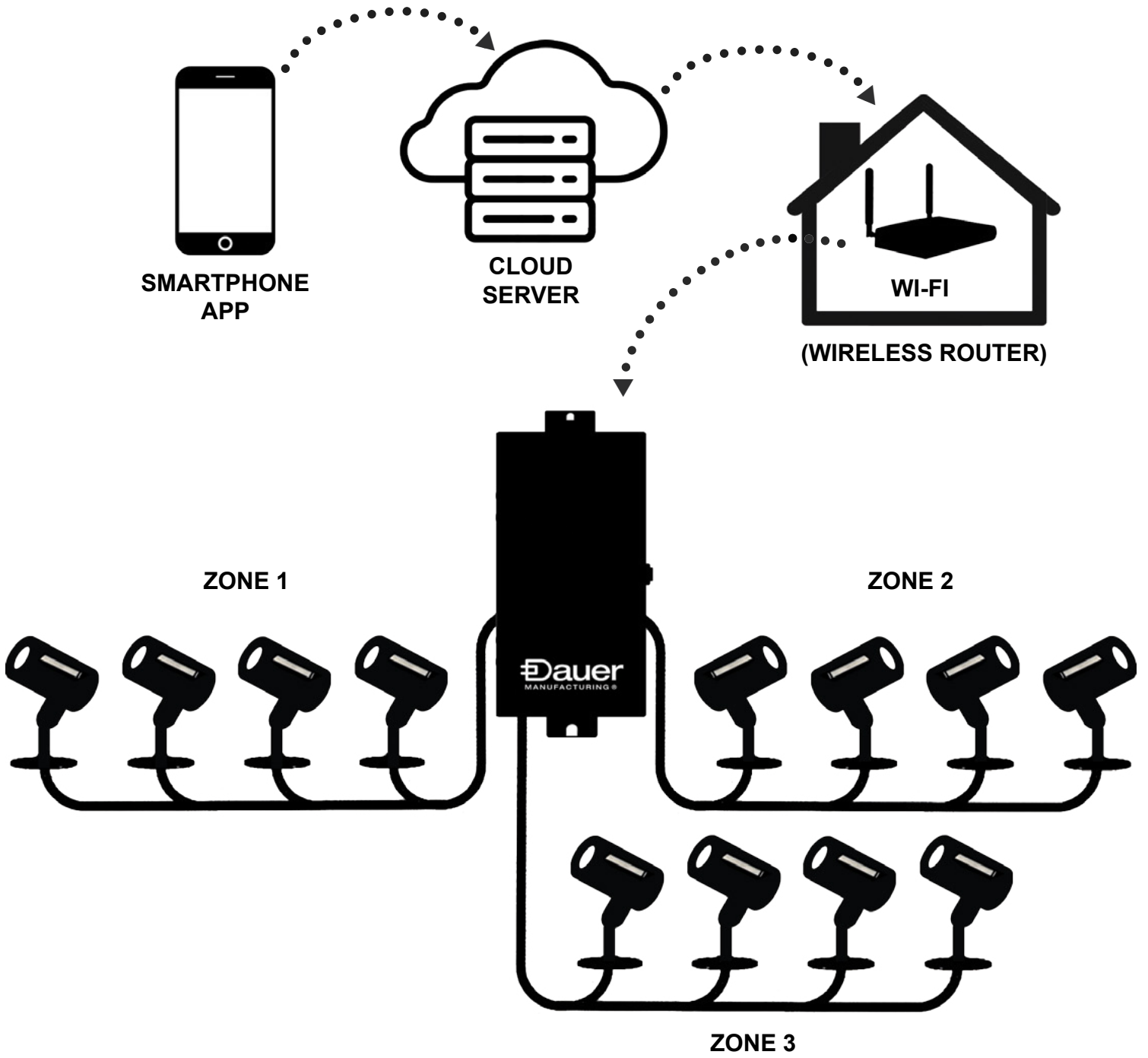

# CHAPTER 1: Programming JARVIS 300W Smart Transformer

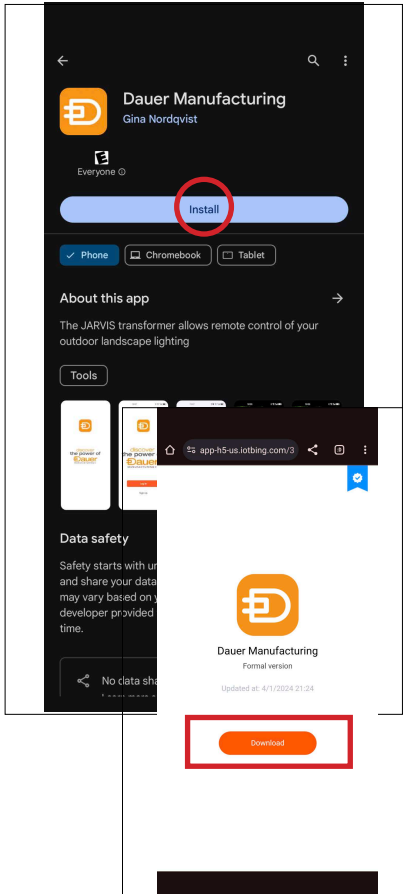

Step 1 | Fig. 1:

Search for the app on your electronic device. If you have not downloaded this app before, press "OPEN" and then "GET or INSTALL".

From the QR Code, press "download" to go to the "Dauer Manufacturing" app.

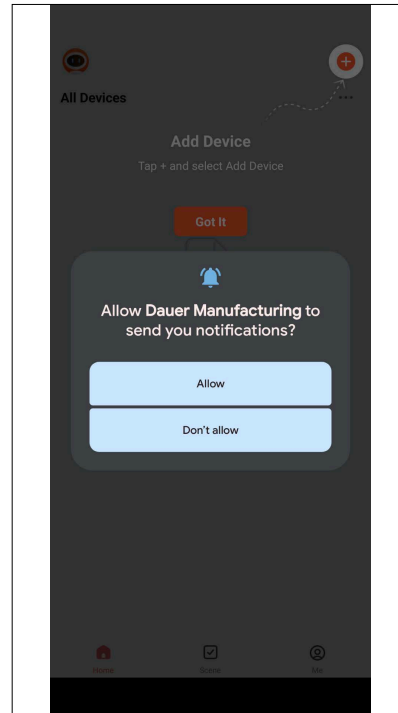

Step 1 | Fig. 2:

Select whether or not you would like the app to allow or not allow notifications

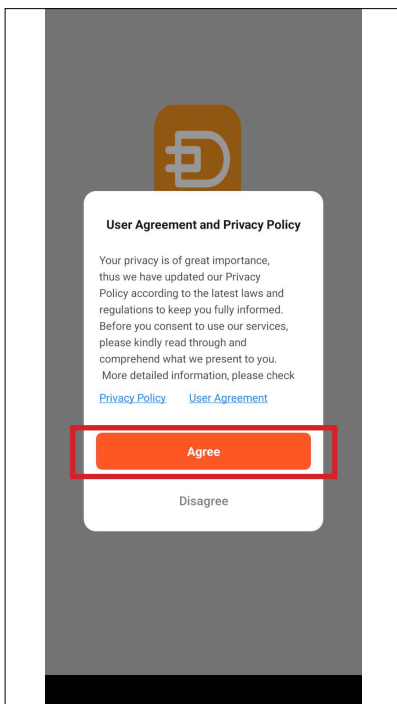

Step 1 | Fig. 3:

Press "Agree" to accept the user agreement and privacy policy.

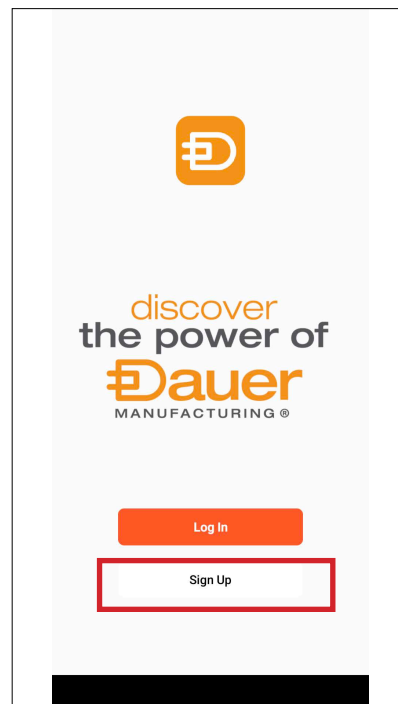

Step 1 | Fig. 4:

Press "Sign Up".

# CHAPTER 1: Programming JARVIS 300W Smart Transformer

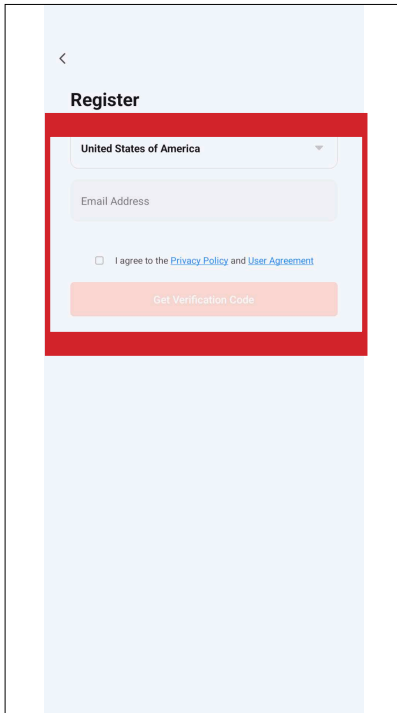

Step 1 | Fig. 5:

Enter your country and email address. Agree to the policies and statements, and press “Get Verification code”. Check your email for the access code from Dauer.

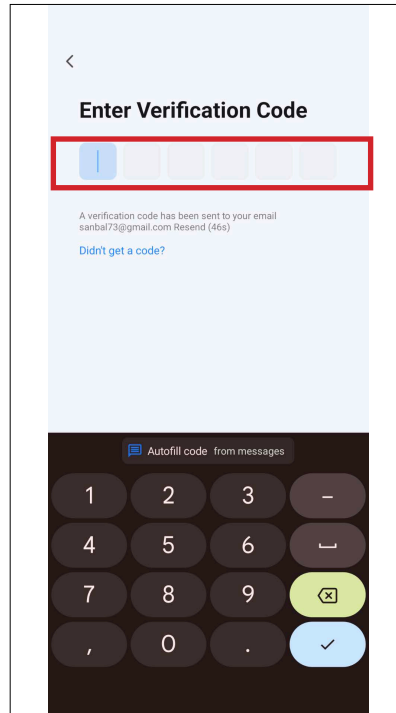

Step 1 | Fig. 6:

Enter the verification code.

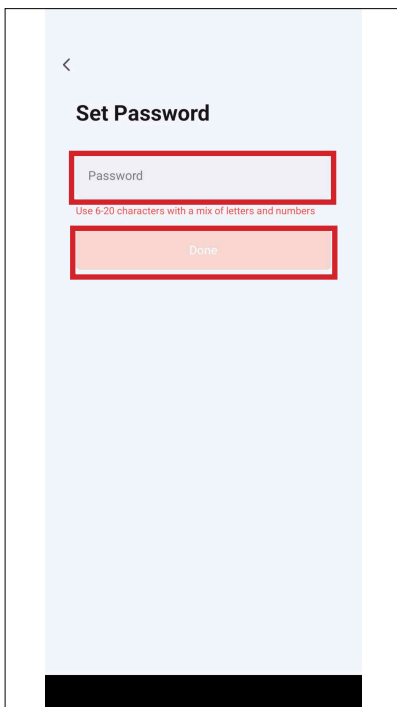

Step 1 | Fig. 7:

Set your password and press “Done”.

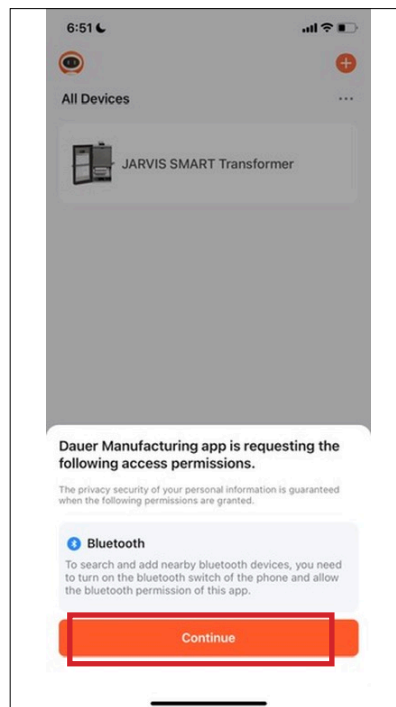

Step 1 | Fig. 8:

Allow for Bluetooth and Press “Continue”.

# CHAPTER 1: Programming JARVIS 300W Smart Transformer

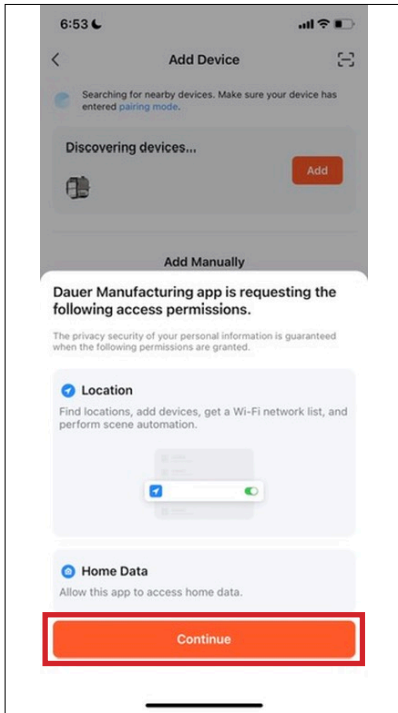

Step 1 | Fig. 9:

Allow Location and Home Data the Press "Continue"

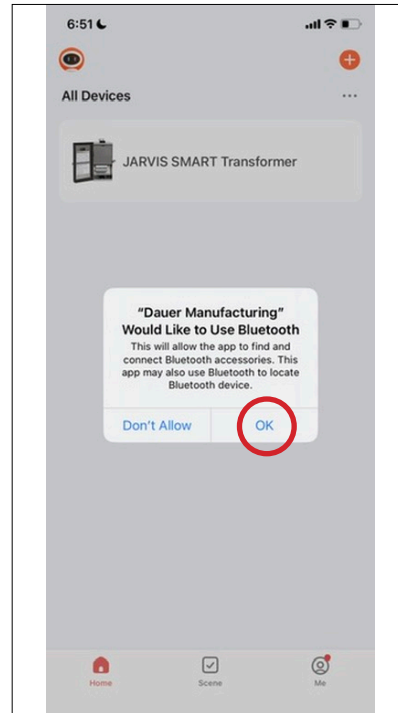

Step 1 | Fig.10:

Allow for Bluetooth and Press "OK".

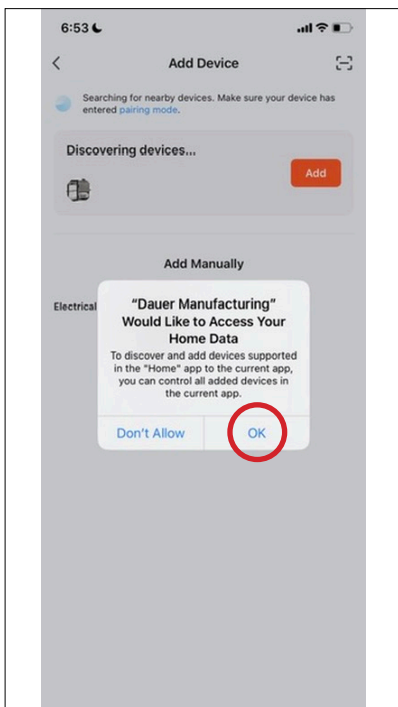

Step 1 | Fig. 11:

Allow Access to Home Data and Press "OK".

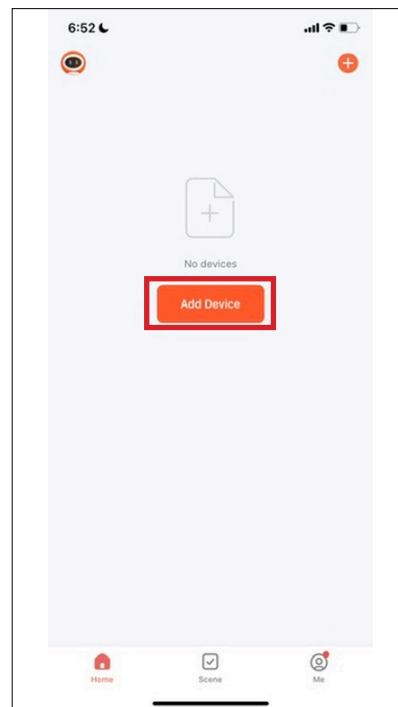

Step 1 | Fig. 12:

Press "Add Device".

# CHAPTER 1: Programming JARVIS 300W Smart Transformer

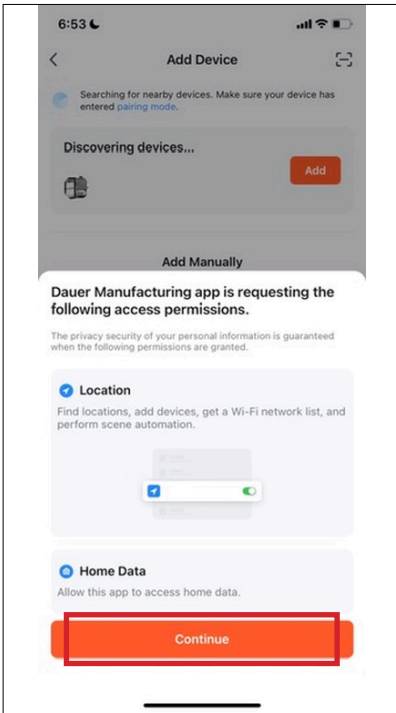

Step 1 | Fig. 13:

Share Location and Home Data and Press "Continue".

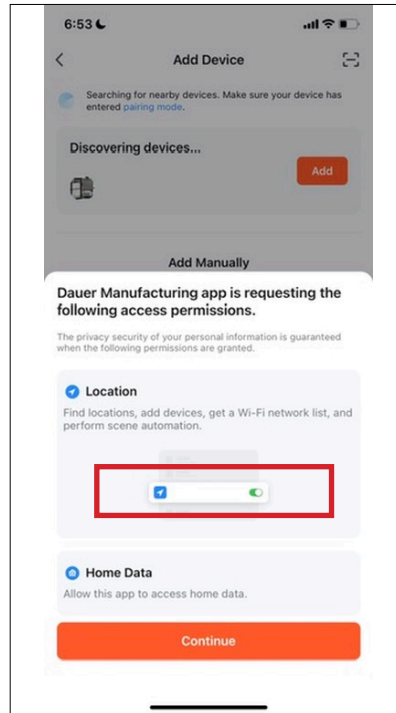

Step 1 | Fig. 14:

Press "Allow While Using App".

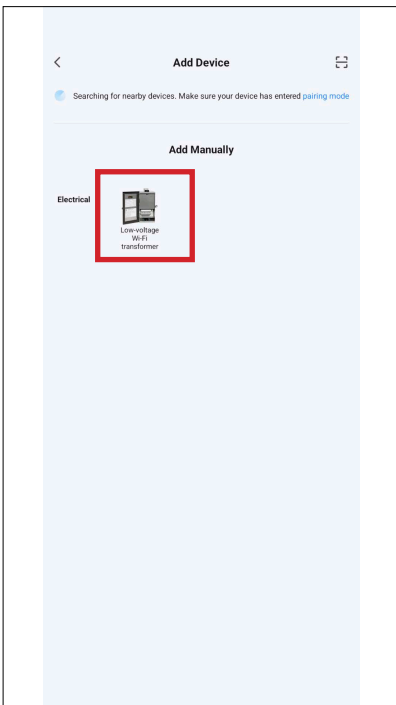

Step 1 | Fig. 15:

Select the Jarvis Transformer.

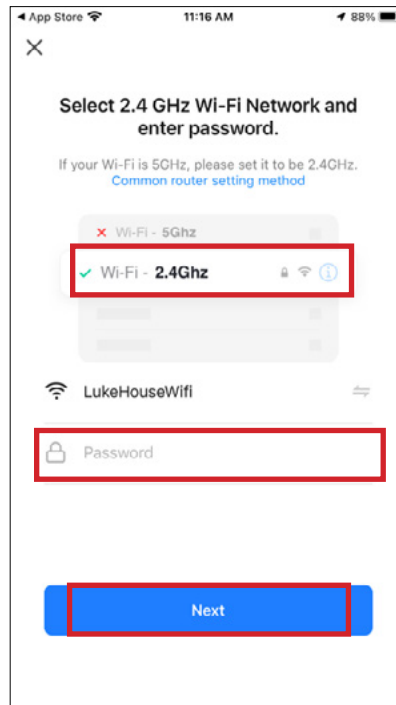

Step 1 | Fig. 16:

Select 2.4GHz Wi-Fi Network and enter your password. Press "Next".

# CHAPTER 1: Programming JARVIS 300W Smart Transformer



Step 1 | Fig. 17:  
Unplug the transformer from the wall outlet for at least 10 seconds before you proceed to the next step.



Step 1 | Fig. 18:  
Press on the programming button located on the face of the transformer and hold for 5 seconds. Then press “Next” on the App.



Step 1 | Fig. 19:  
Once the indicator light is blinking, press “Next”. On the App.

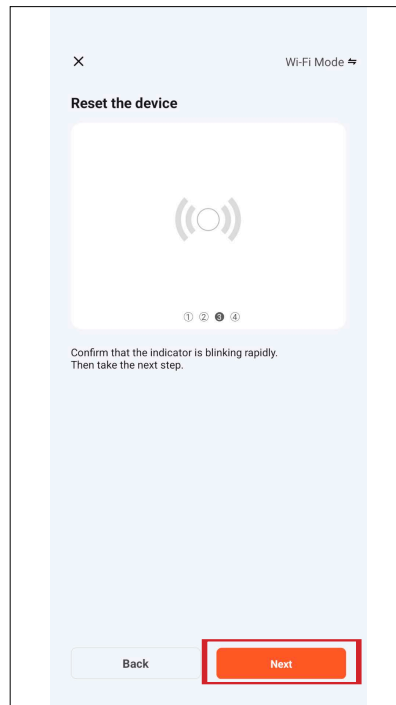

Step 1 | Fig. 20:  
Confirm the indicator light of the transformer is blinking quickly. If so, press “Next”.

# CHAPTER 1: Programming JARVIS 300W Smart Transformer

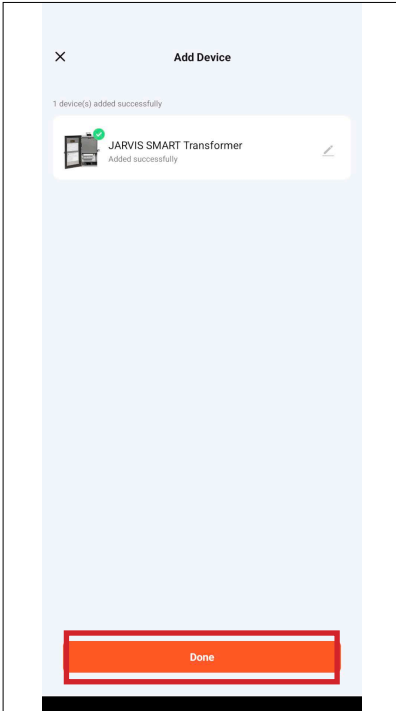

Step 1 | Fig. 21:

Program pairing begins Once the transformer is added successfully, you can select the “pencil” icon to rename your device. Then press “Done.”

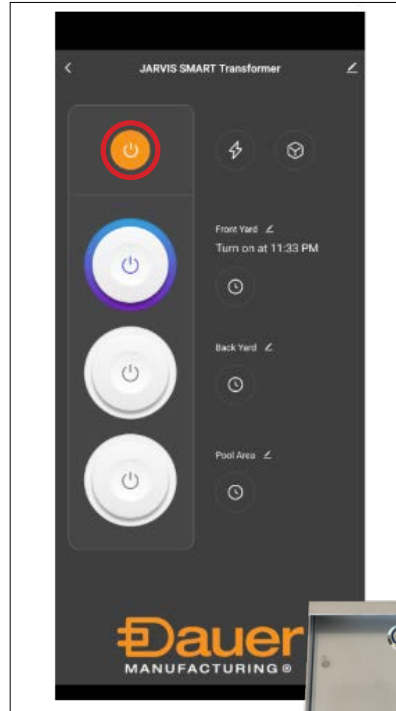

Step 1 | Fig. 22:

Congratulations! The app and the transformer are ready for operation Please turn on the transformer breaker switch to energize the low voltage/ secondary power.

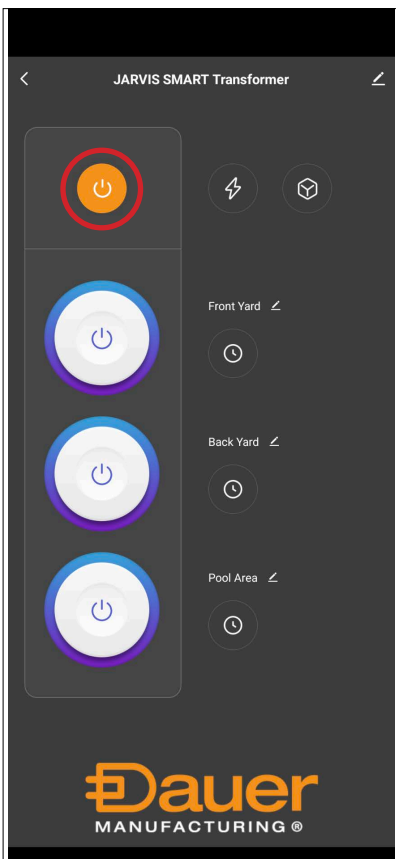

Step 1 | Fig. 23:

Press on the Power button on on your control panel to turn on the lights.

Presto! You're ready to go!

# CHAPTER 2: Name Your Zones

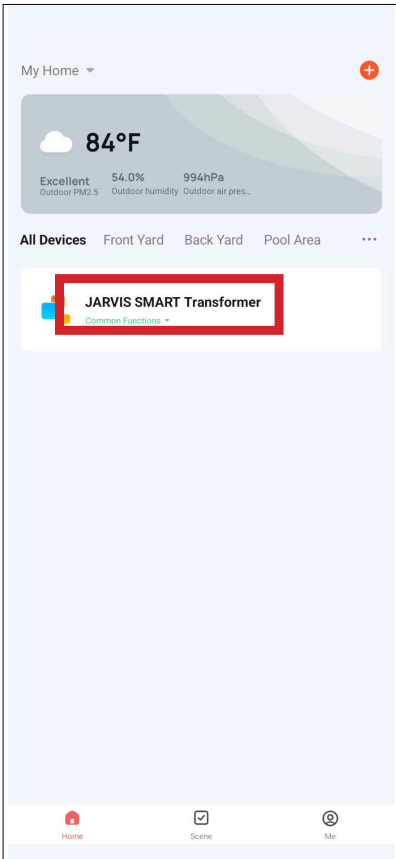

Step 2 | Fig. 1:

From your Home Page, press on the transformer tab you wish to program.

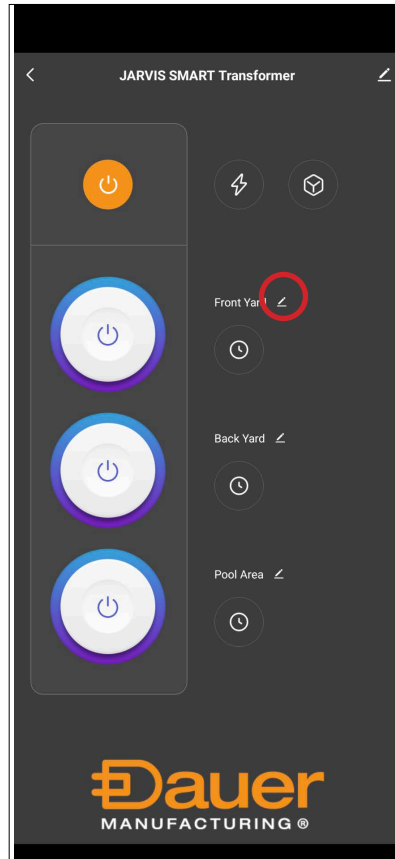

Step 2 | Fig. 2:

To set up Zone 1, click on the pencil icon next to "Switch 1".

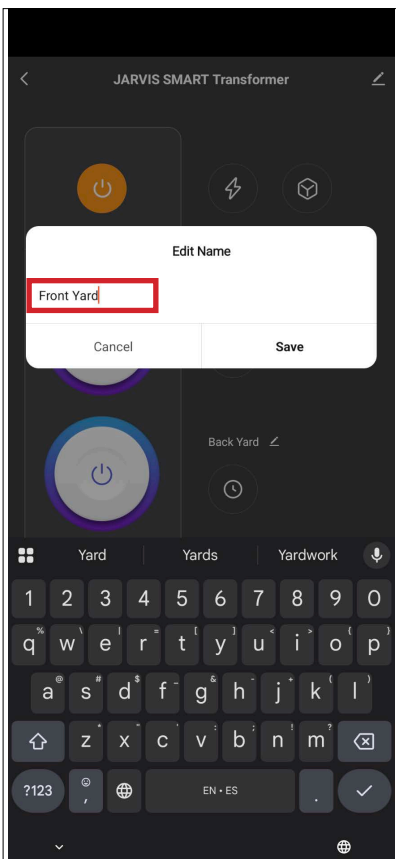

Step 2 | Fig. 3:

Delete the name "Switch 1" and rename the zone. For example, "Front Yard", and press "Save".

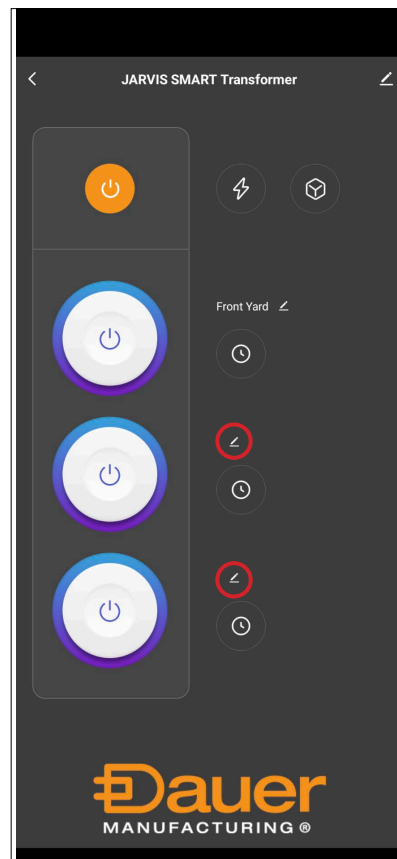

Step 2 | Fig. 4:

Repeat the same steps to set up Zone's 2 and 3.

# CHAPTER 3: Adding Astronomical Timers

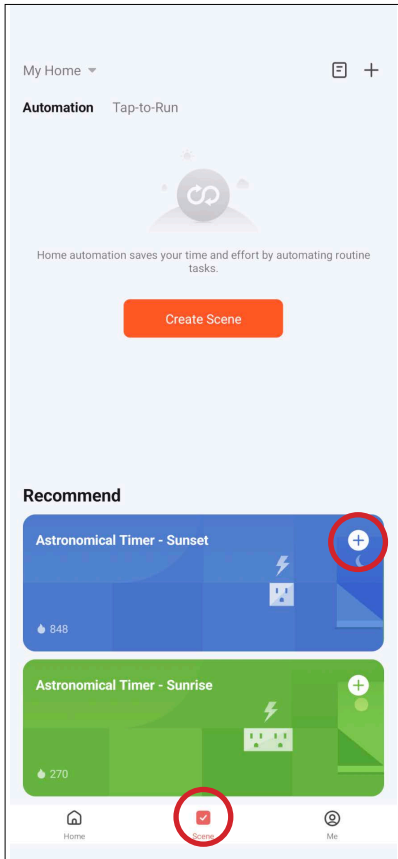

Step 3 | Fig. 1:

From your home page, press the "Scene" tab and Select "Sunset"

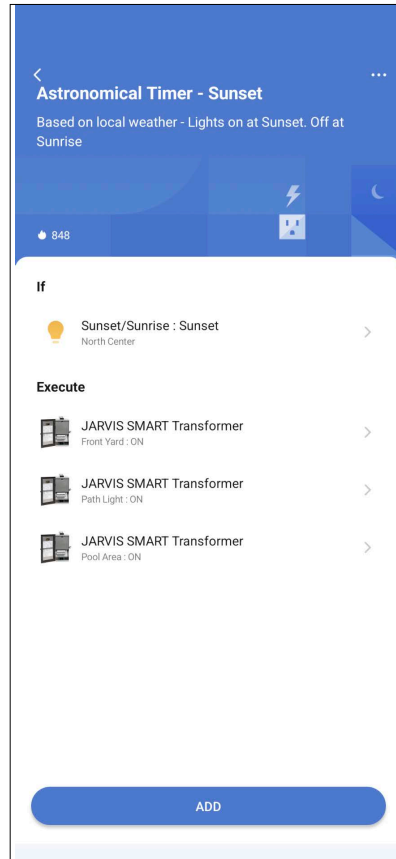

Step 3 | Fig. 2:

This will add the Sunset Schedule to all 3 zones.

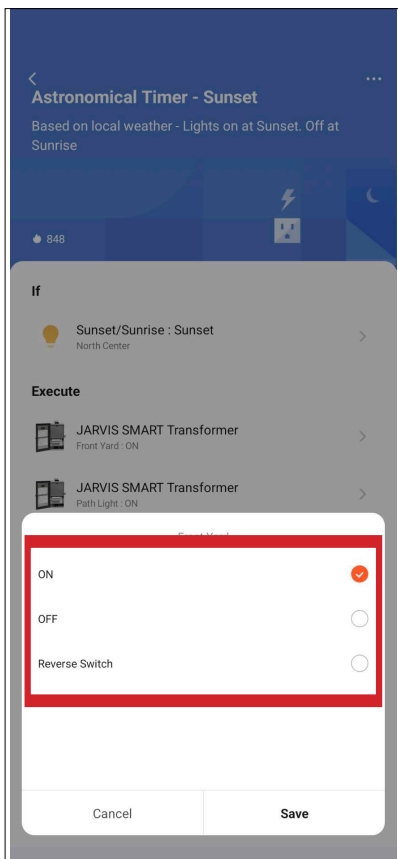

Step 3 | Fig. 3:

Select a Zone to edit, then click "Save"

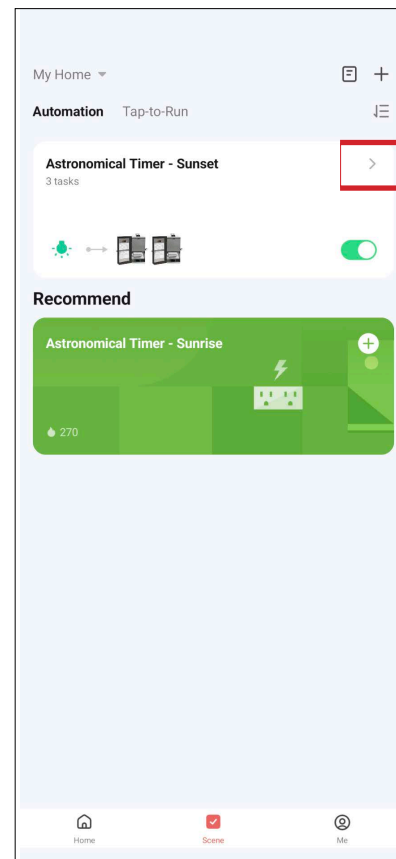

Step 3 | Fig. 4:

To add, Edit or Remove devices from the scheduler, select the arrow to see the details screen.

# CHAPTER 3: Adding Astronomical Timers

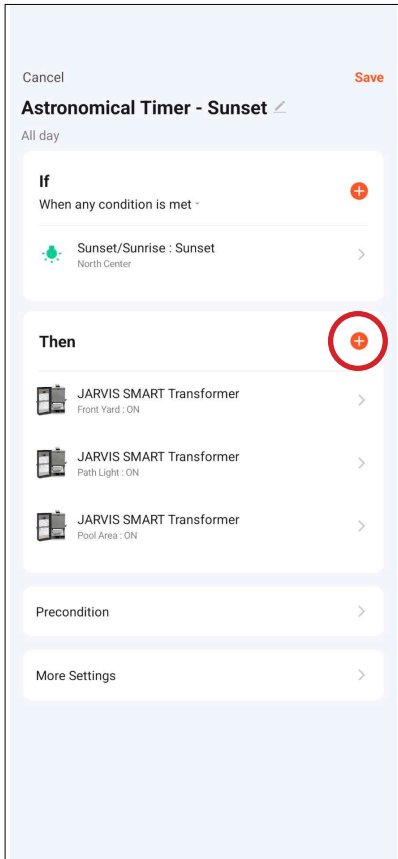

Step 3 | Fig. 5:

Press the "+" to add more devices

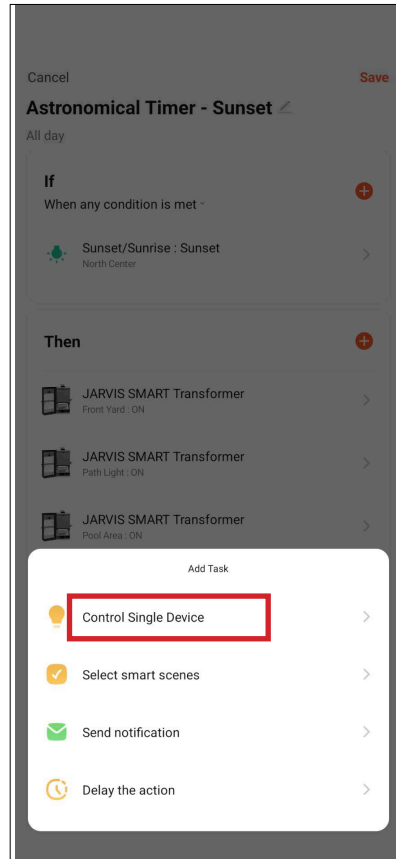

Step 3 | Fig. 6:

Press "Control Single Device" to select the device to add

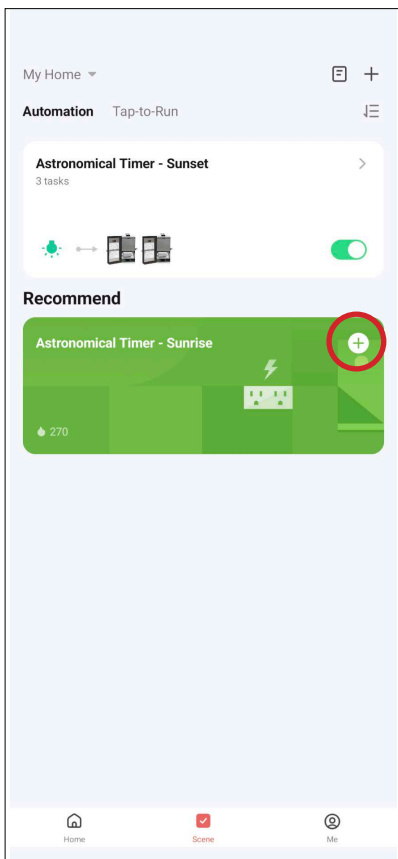

Step 3 | Fig. 7:

Repeat these steps to add Sunrise schedule.

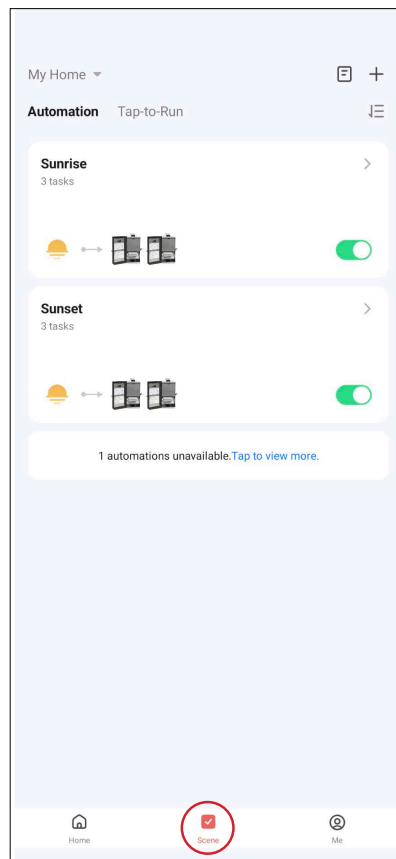

Step 3 | Fig. 8:

You can now access the Astronomical timer settings from the "Scene" tab

# CHAPTER 4: Scheduling Your Zones

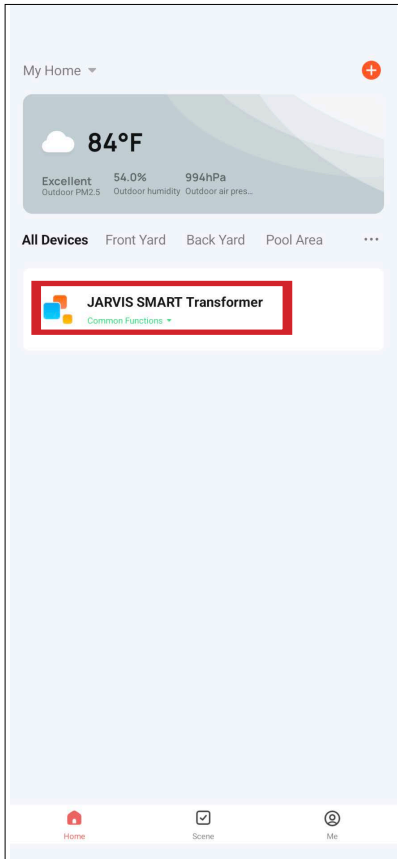

Step 4 | Fig. 1:

From your home page, press on the “Jarvis Transformer” to program.

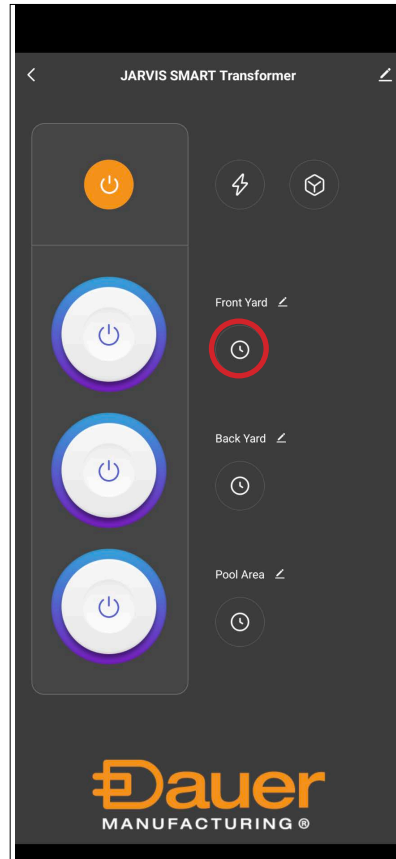

Step 4 | Fig. 2:

Press the Clock icon for the zone you wish to set to a specific time schedule.

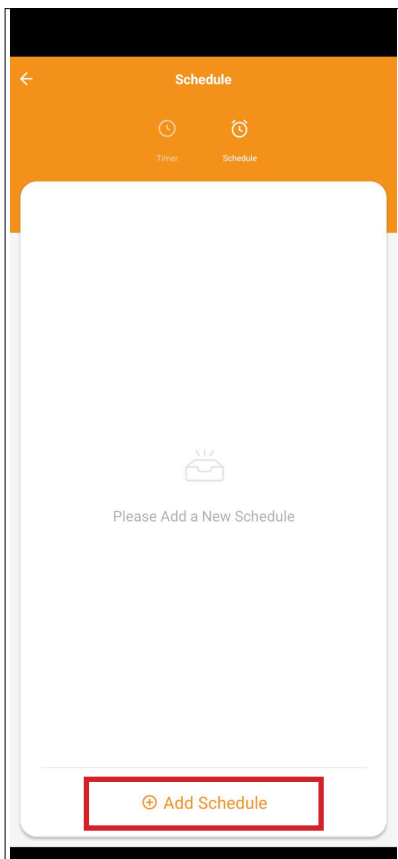

Step 4 | Fig. 3:

Press “Add Schedule”.

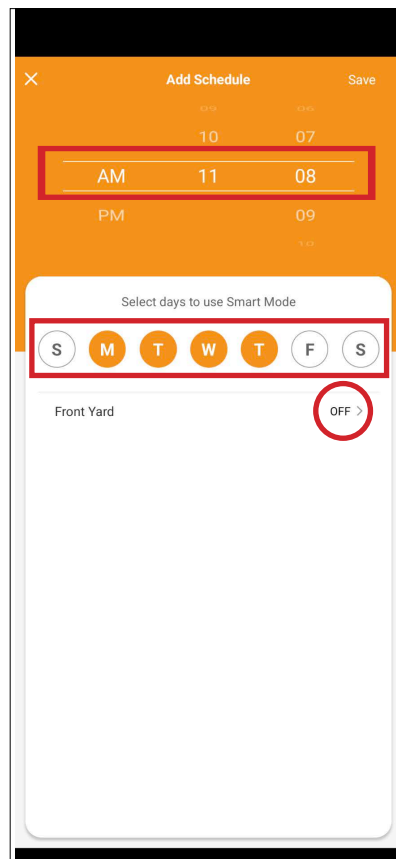

Step 4 | Fig. 4:

Select the days of the week you choose the lights to turn “OFF” or “ON” by pressing on the respective icons. Then set the time. Then press on the “ON” icon regardless if you want them ON or OFF.

## CHAPTER 4: Scheduling Your Zones

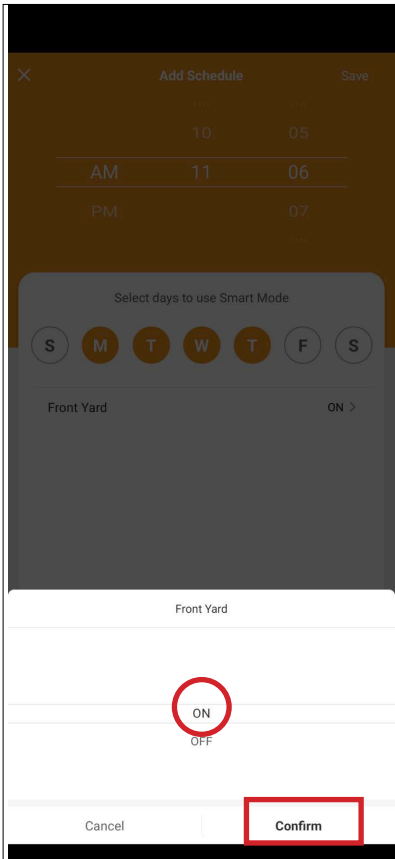

Step 4 | Fig. 5:

Select "ON" or "OFF" and press "Confirm".

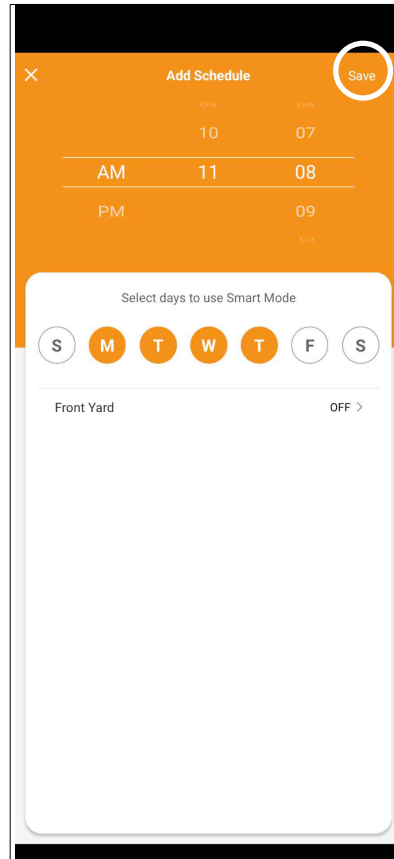

Step 4 | Fig. 6:

Press "Save".

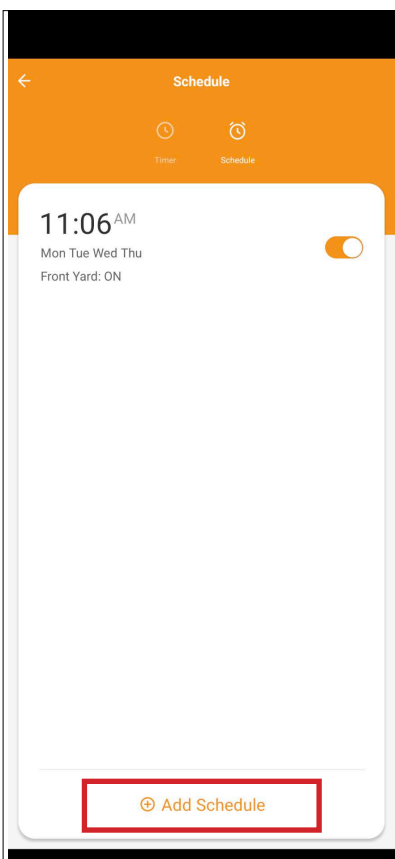

Step 4 | Fig. 7:

This completes the scheduling process unless you wish to add additional commands to any of the remaining days of the week. If so, press the "Add Schedule" tab.

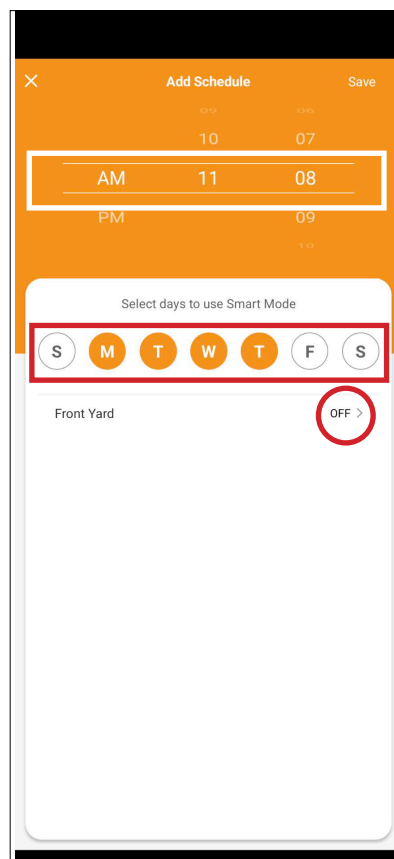

Step 4 | Fig. 8:

Select the days of the week you choose the light to turn "OFF" or "ON" by pressing the respective icons and then setting the time. Then press the "ON" icon, regardless if you want them ON or OFF.

# CHAPTER 4: Scheduling Your Zones

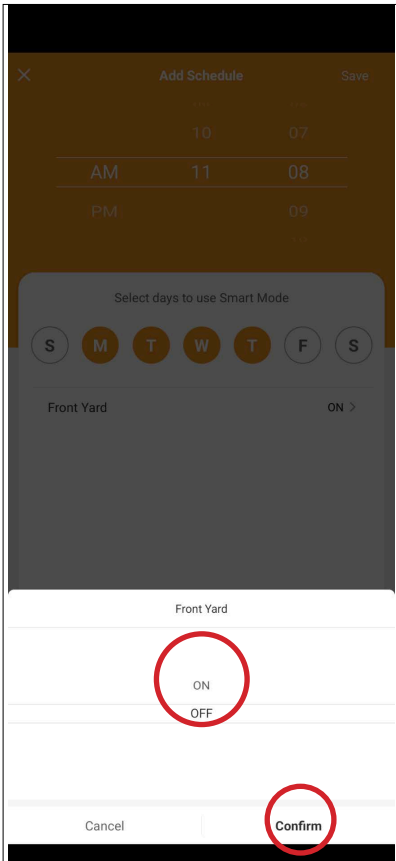

Step 4 | Fig. 9:  
Select "ON" or "OFF" and press "Confirm".

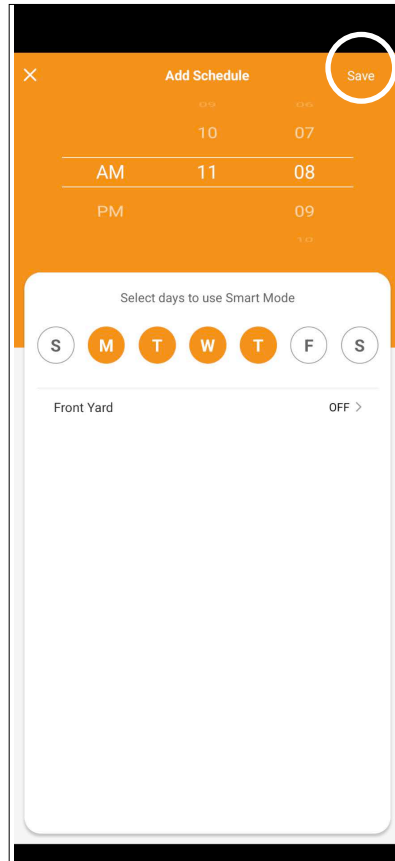

Step 4 | Fig. 10:  
Review your settings and press "Save".

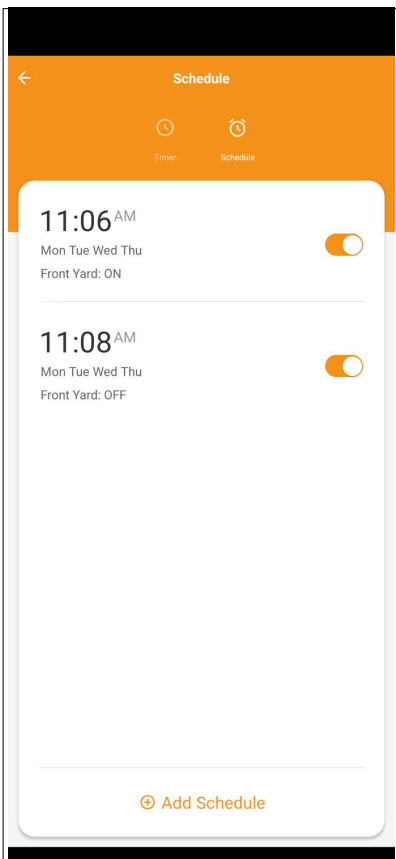

Step 4 | Fig. 11:  
Your setting will be saved.

***\*Follow the same procedure to set your additional ones.\****

# CHAPTER 5: How To Share & Accept Your Smart Transformer

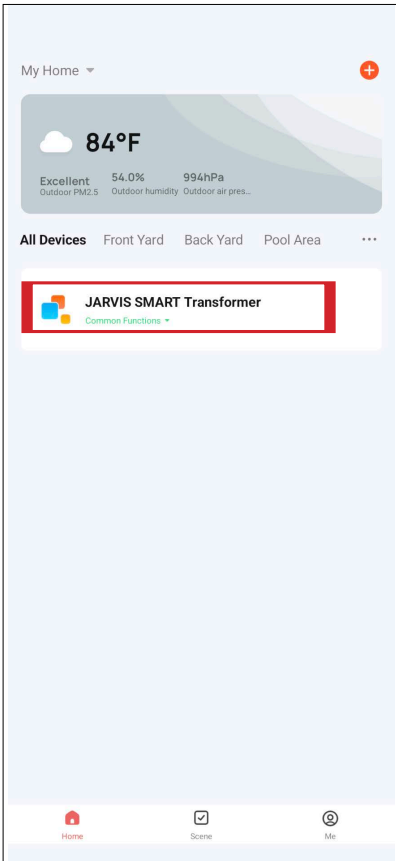

Step 5 | Fig. 1:

Press on your "Transformer" icon.

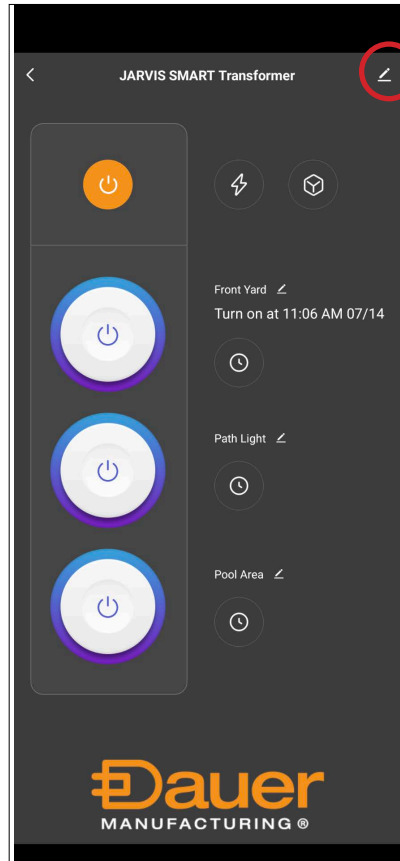

Step 5 | Fig. 2:

Press on the "pencil" tab.

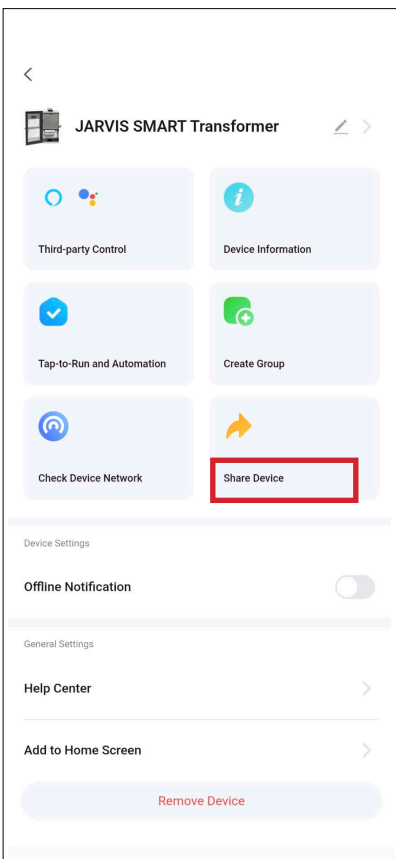

Step 5 | Fig. 3:

Select "Share Device".

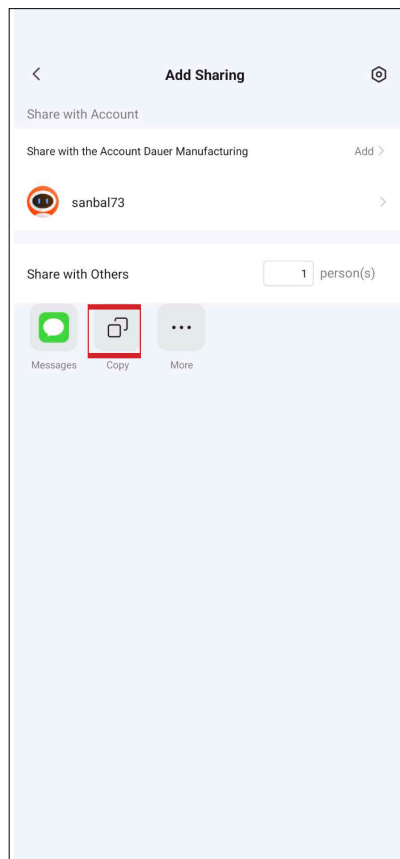

Step 5 | Fig. 4:

Press on "copy"

# CHAPTER 5: How To Share & Accept Your Smart Transformer

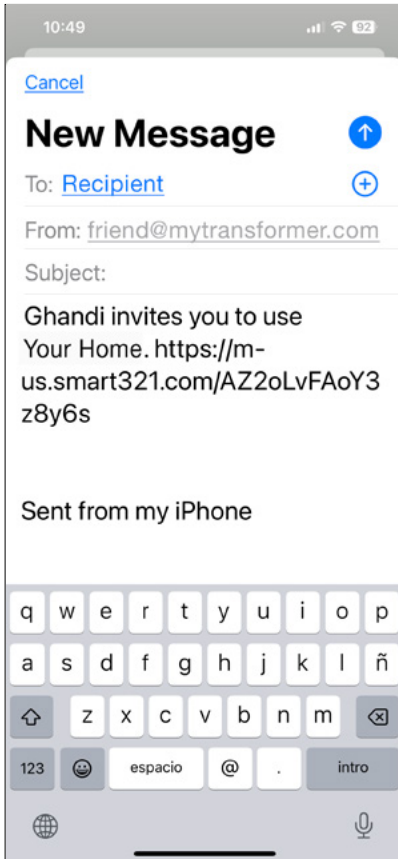

Step 5 | Fig. 5:

Share your Smart transformer by text, email or any other compatible app on your device by pasting the link.

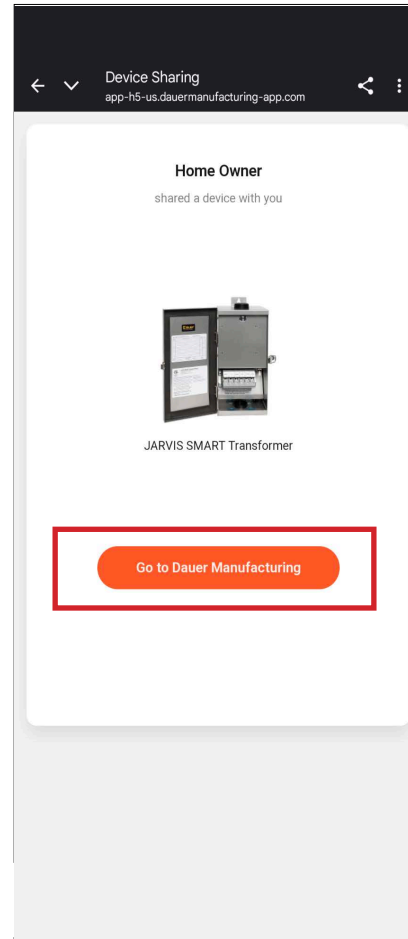

Step 5 | Fig. 6:

The user will be taken to this screen on the Daurer App after clicking the link.

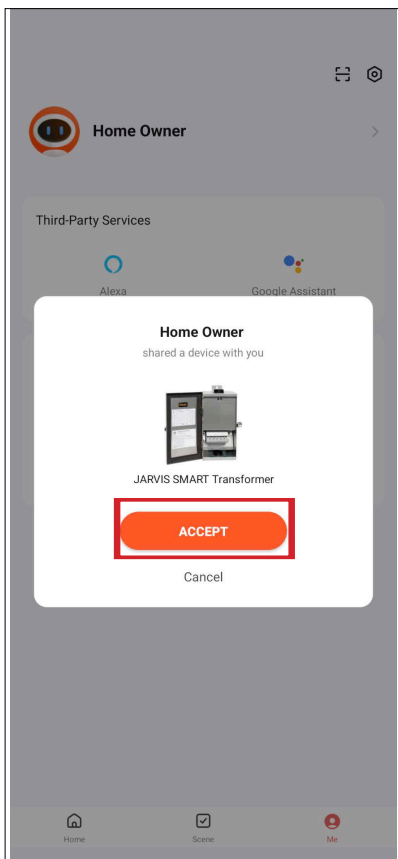

Step 5 | Fig. 7:

“Shared successfully” indicates your device has been shared with your recipient.

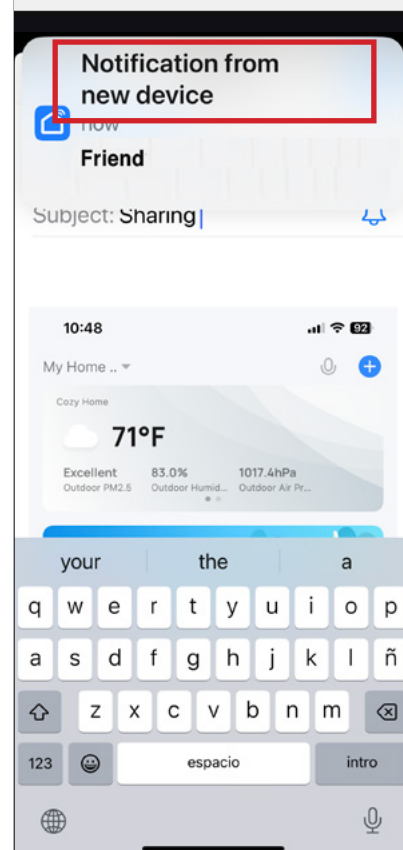

Step 5 | Fig. 8:

When you share your transformer, your recipient will also receive a “notification from new device”.

# CHAPTER 5: How To Share & Accept Your Smart Transformer

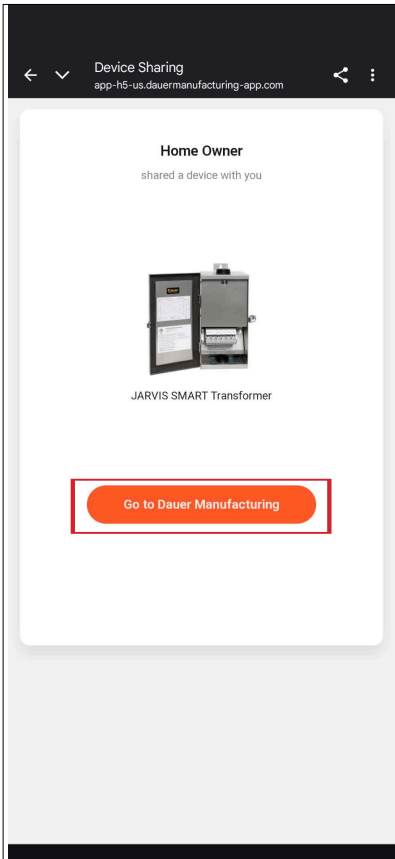

Step 5 | Fig. 9:

The sender's Smart Transformer will appear on the recipient's home page under "Devices Shared with Me". The recipient will press on the sender's Smart Transformer icon

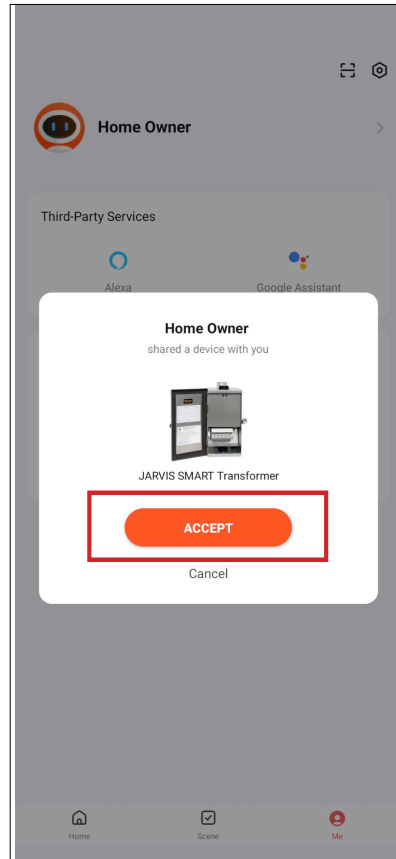

Step 5 | Fig. 10:

The recipient will press "Accept".

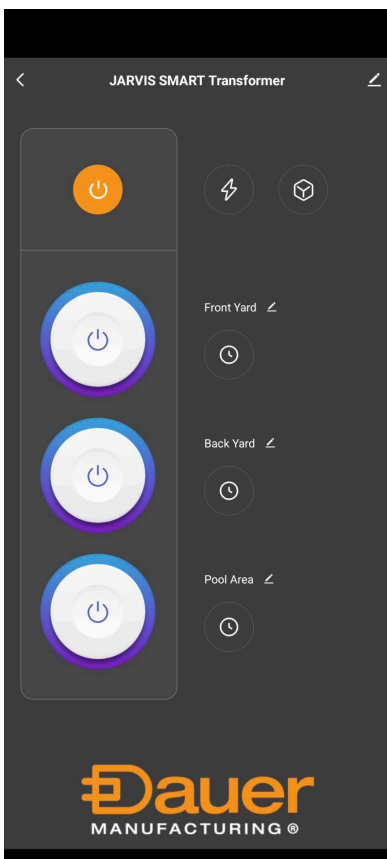

Step 5 | Fig. 11:

The recipient now has access to the shared transformer.

# CHAPTER 5a: How To Unshare Your Smart Transformer

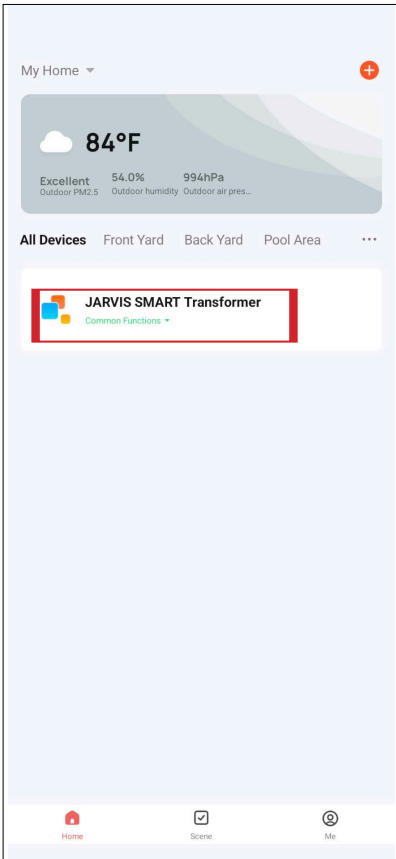

Step 5a | Fig. 1:

To remove a shared transformer from your app, go to your home page and select the device you would like to remove.

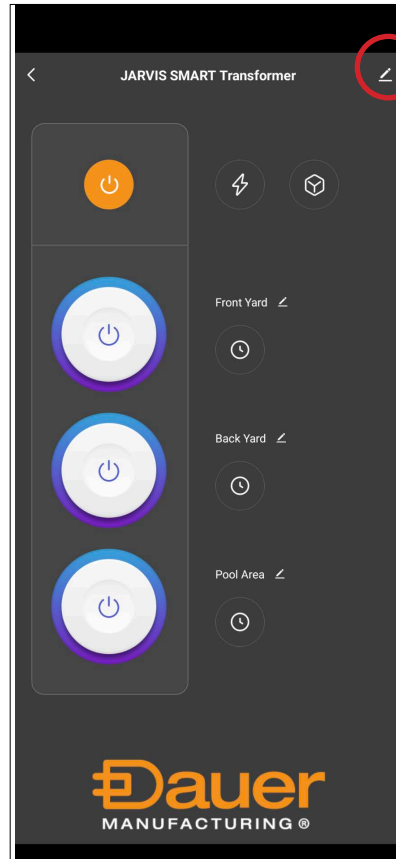

Step 5a | Fig. 2:

Once the device to be removed is selected, you will see the control panel for that device. Press on the pencil icon.

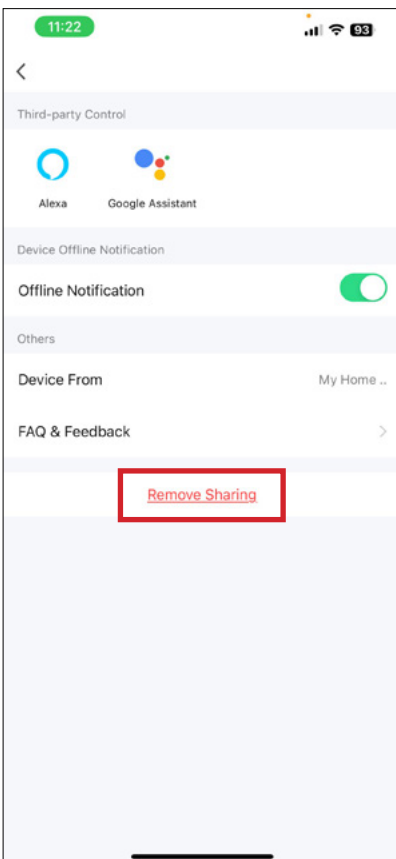

Step 5a | Fig. 3:

Press "Remove sharing".

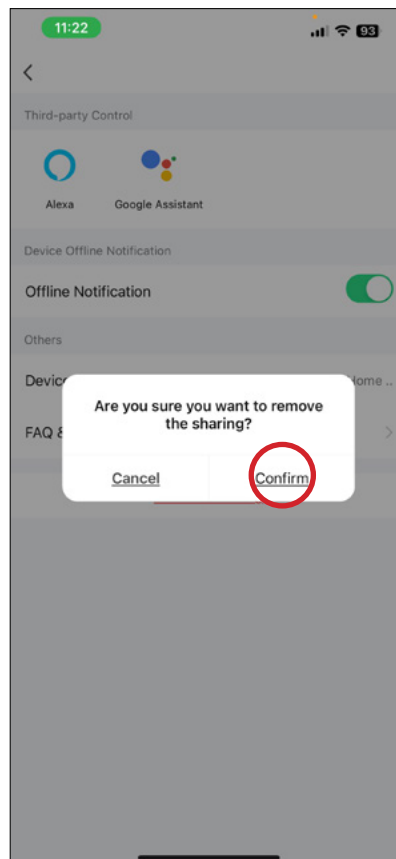

Step 5a | Fig. 4:

Press "Confirm".

## CHAPTER 5a: How To Unshare Your Smart Transformer

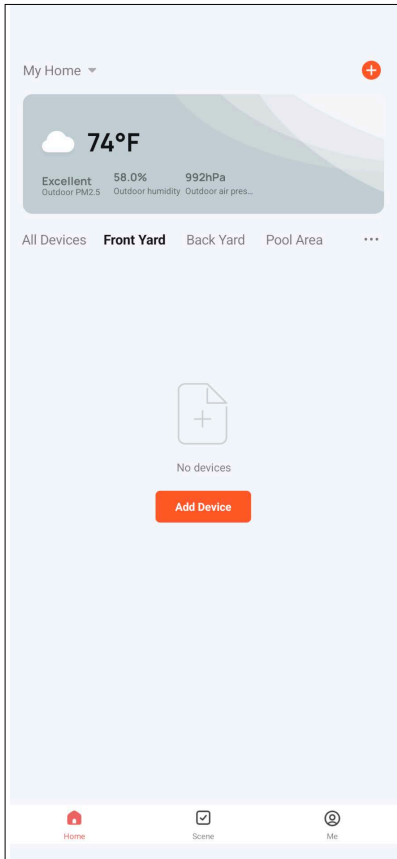

Step 5a | Fig. 5:

**Device is no longer visible on your transformer screen.**

# CHAPTER 6: Transformer Power Consumption

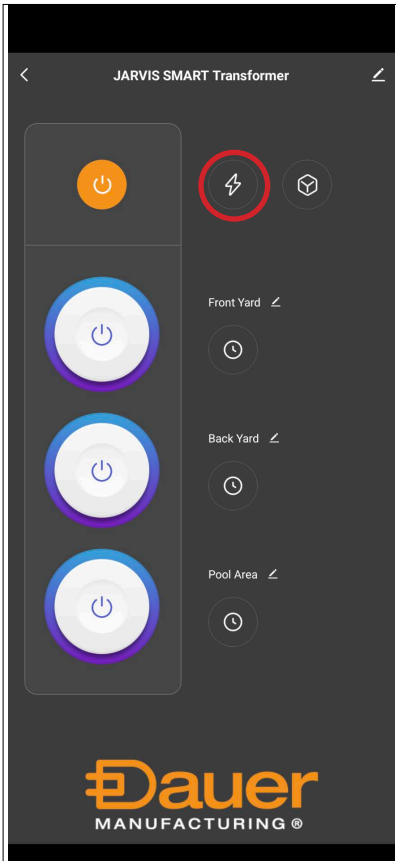

Step 6 | Fig. 1:

Press the lightning bolt icon on your control panel.

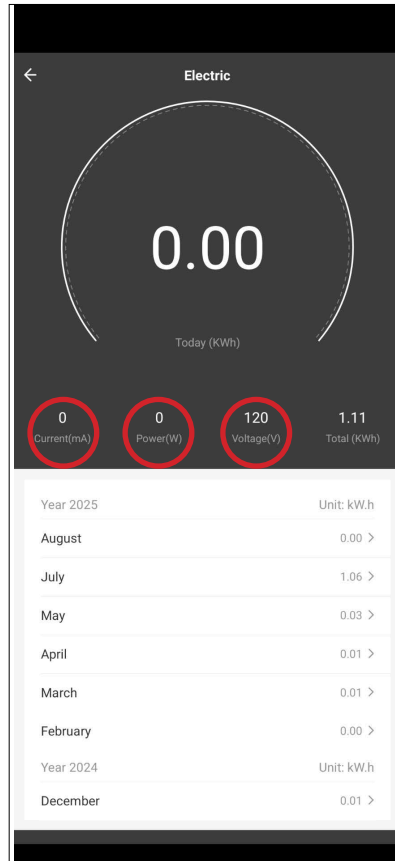

Step 6 | Fig. 2:

This screen shot shows that there is no load on the transformer because the power is turned OFF. It also shows the input voltage going to the transformer.

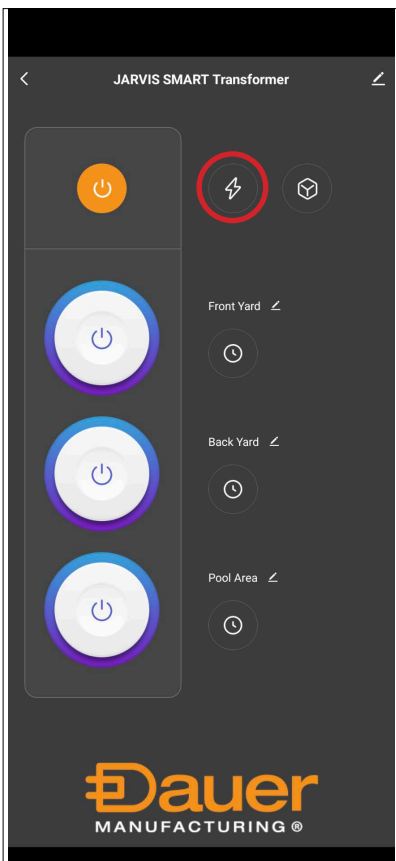

Step 6 | Fig. 3:

With the power ON, let's see what the power draw is on the transformer. Press the "lightning bolt" icon.

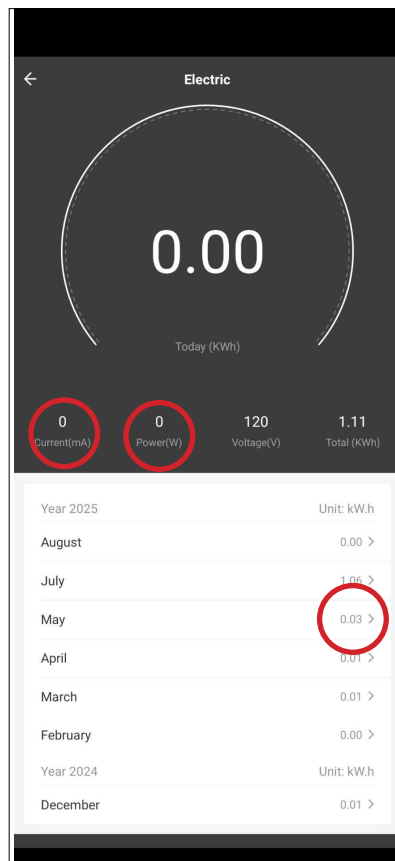

Step 6 | Fig. 4:

This feature not only shows you what the total power consumption in Watts, but it also accounts for wire losses! It also provides the total KW consumed by the system.

# CHAPTER 7: Device Info & Running Systems Diagnostics

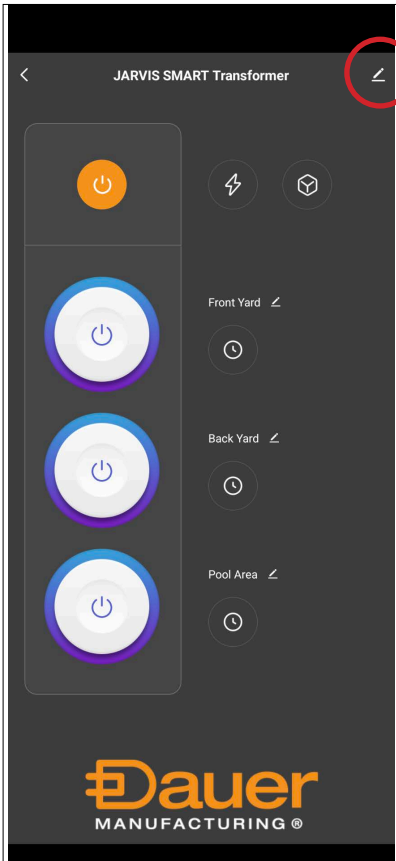

Step 7 | Fig. 1:

From your control panel, press on the “pencil” icon.

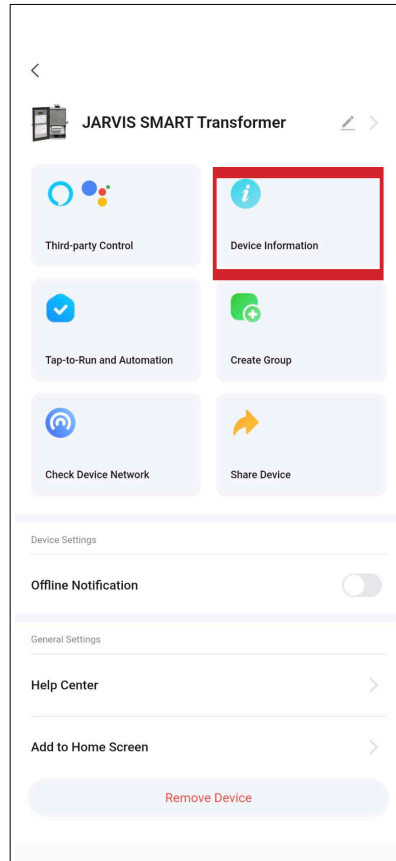

Step 7 | Fig. 2:

Select the “Device Information” tab.

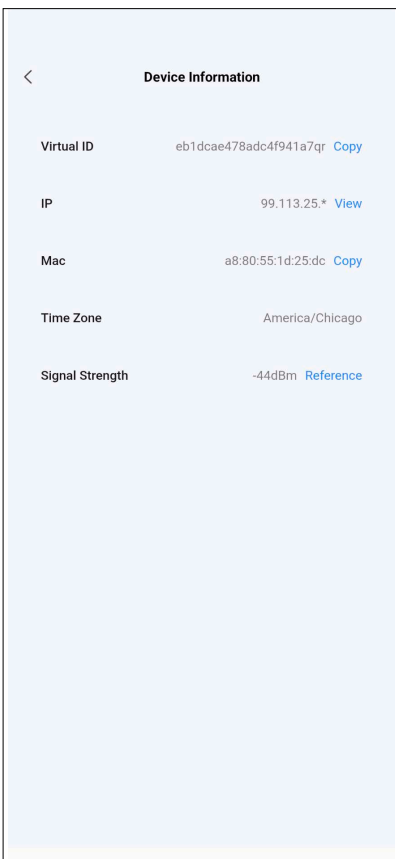

Step 7 | Fig. 3:

This shows you what time zone your device is set on and the Wi-Fi signal strength.

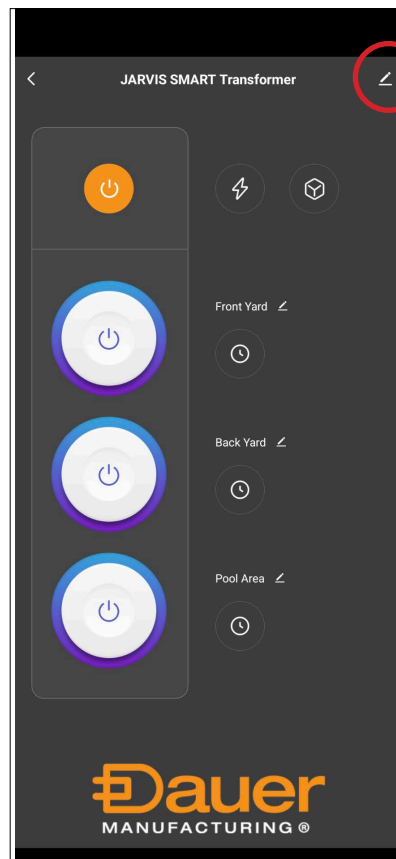

Step 7 | Fig. 4:

From your control panel, press on the “pencil” icon.

## CHAPTER 7: Device Info & Running Systems Diagnostics

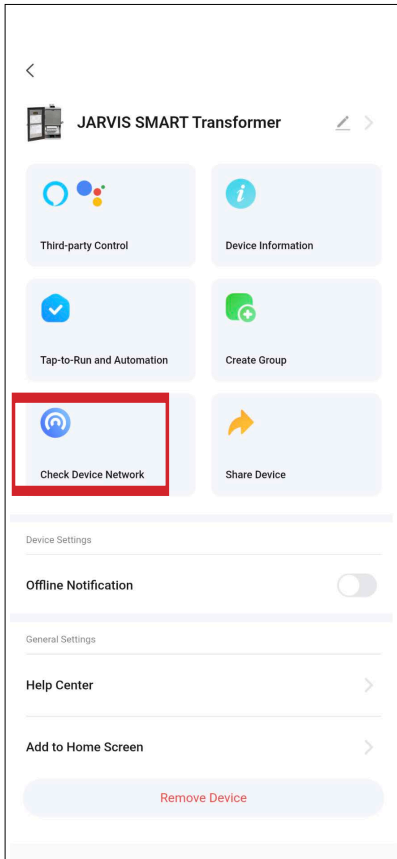

Step 7 | Fig. 5:

Select  
“Check  
Device  
Network”.

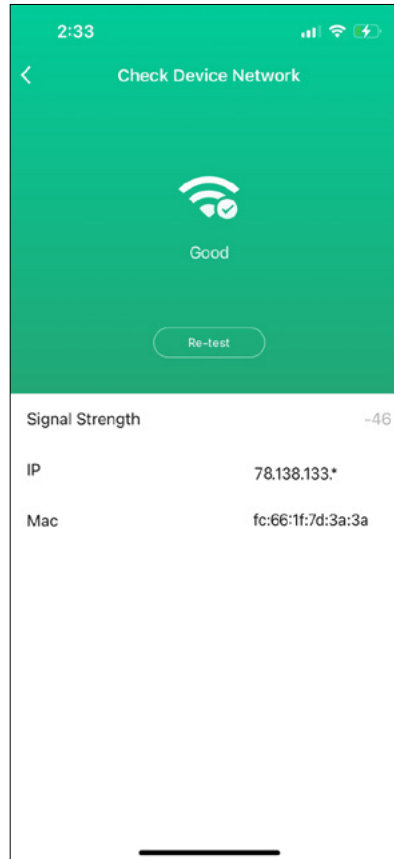

Step 7 | Fig. 6:

You can check  
the quality of  
your signal  
strength within  
seconds.

## CHAPTER 8: Set Up Bluetooth Control Mode

First you **MUST** follow and complete the WI-FI set up. This is necessary because all of the control settings are stored in the cloud, not in the transformer. Please see Chapter 1 in the instruction manual.

Once you have completed the pairing of the app to the smart transformer via Wi-Fi, simply go to your phone settings and turn on your WI-FI and your cellular settings and you will automatically be in Bluetooth control mode.

To operate in Bluetooth mode, you must be within 30 meters of the Smart Transformer.

# CHAPTER 9: Alexa Set Up

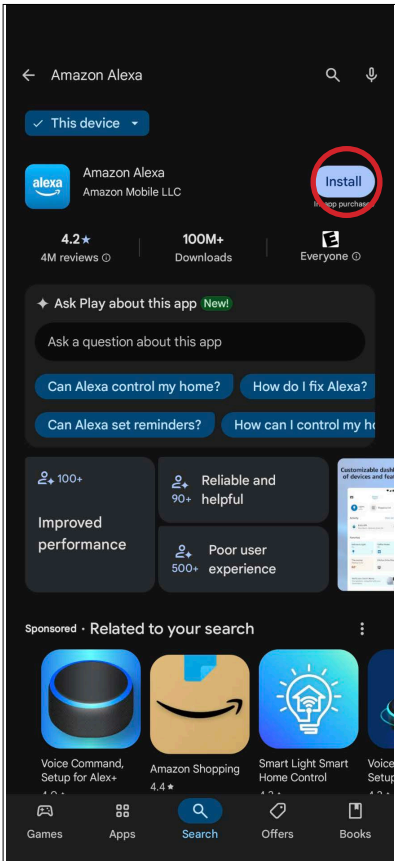

Step 9 | Fig. 1:

Download the Alexa app to your phone. (Iphone, Android)

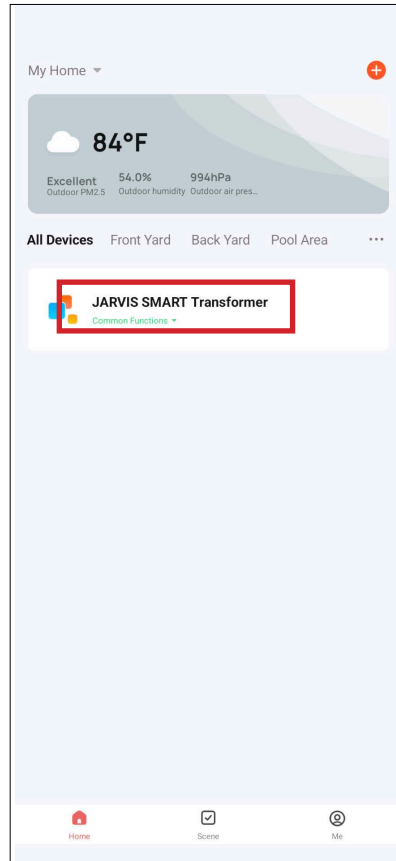

Step 9 | Fig. 2:

Once installed and logged in. Go back to the Dauer App and click on the Jarvis Transformer

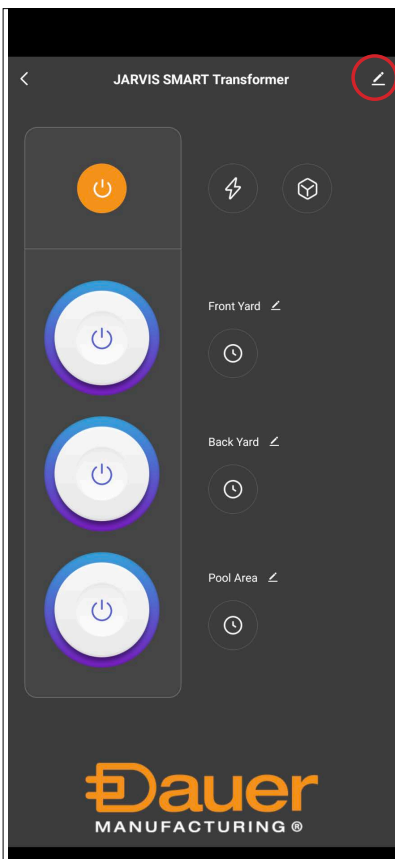

Step 9 | Fig. 3:

Then click on the edit button.

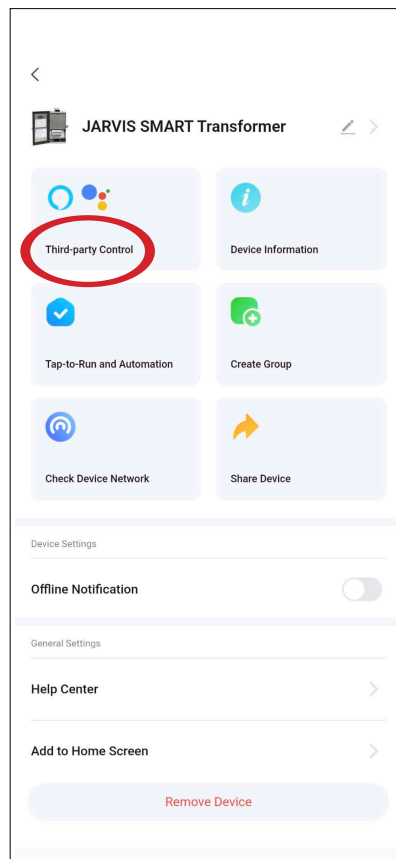

Step 9 | Fig. 4:

Click on "Third Party Control"

# CHAPTER 9: Alexa Set Up

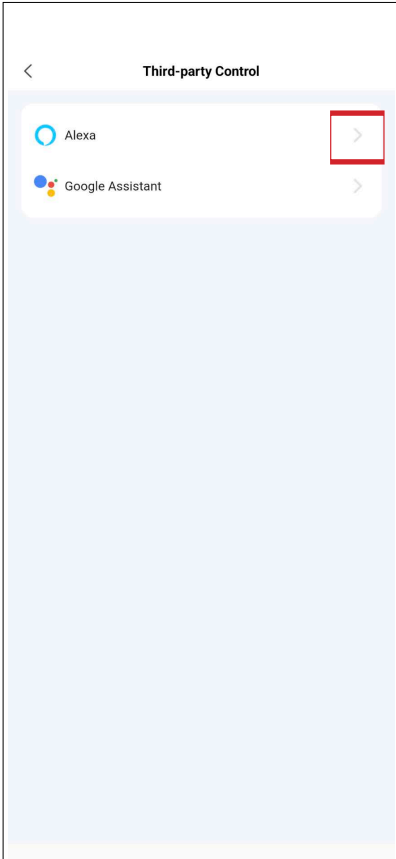

Step 9 | Fig. 5:

Select "Alexa"

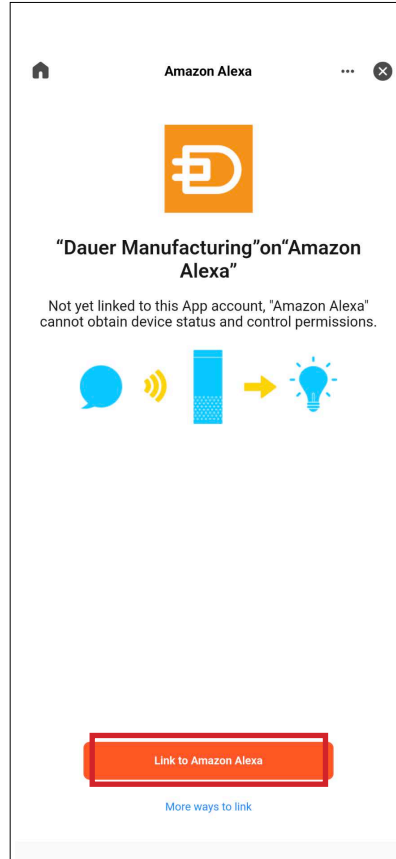

Step 9 | Fig. 6:

Once your Alexa app is detected, click on "Link to Amazon Alexa."

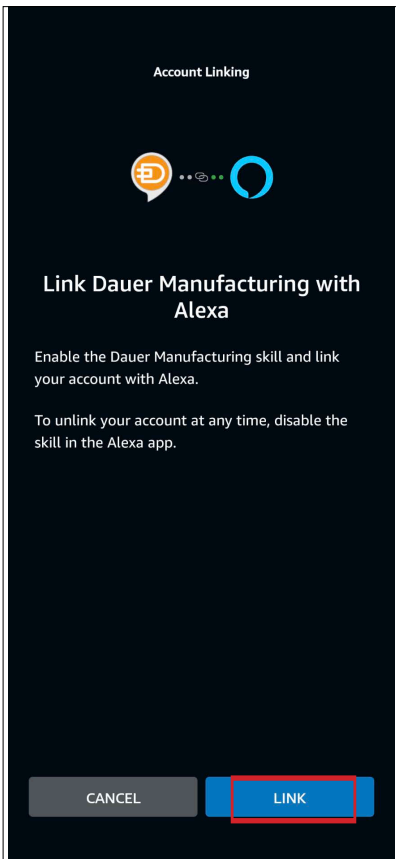

Step 9 | Fig. 7:

Link the device to your Alexa Account by Selecting "Link"



Step 9 | Fig. 8:

Confirmation screen. You have now linked to your Alexa account successfully.

# CHAPTER 9: Alexa Set Up

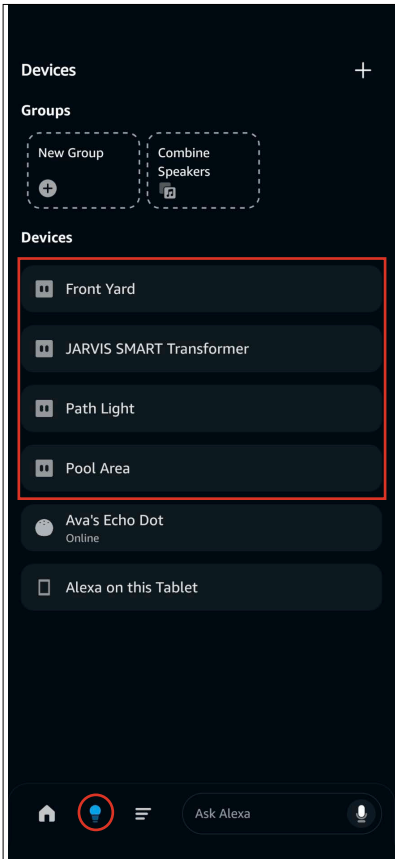

Step 9 | Fig. 9:

You will now see your Device and Zones on the Alexa "Device" screen

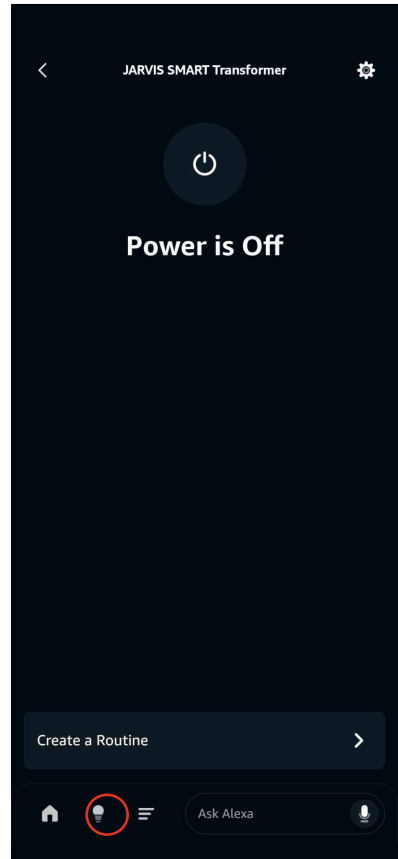

Step 9 | Fig. 10:

You can now control your device and zones from Alexa. You can also create a routine in Alexa or continue to use the Dauer App for scheduling.

# How to give a person Administrator access to troubleshoot or manage your Jarvis Transformer.

In order to add another person to manage your device, you must make sure you have set up a Home Profile first.

## Setup a Home Profile

- Navigate to **Me** → **Home Management**.
- Select **Create a Home**
- Name the new location and **click save**
- You can deselect any or all of the recommended rooms and add your own later
- Alternatively, choose an existing home profile.

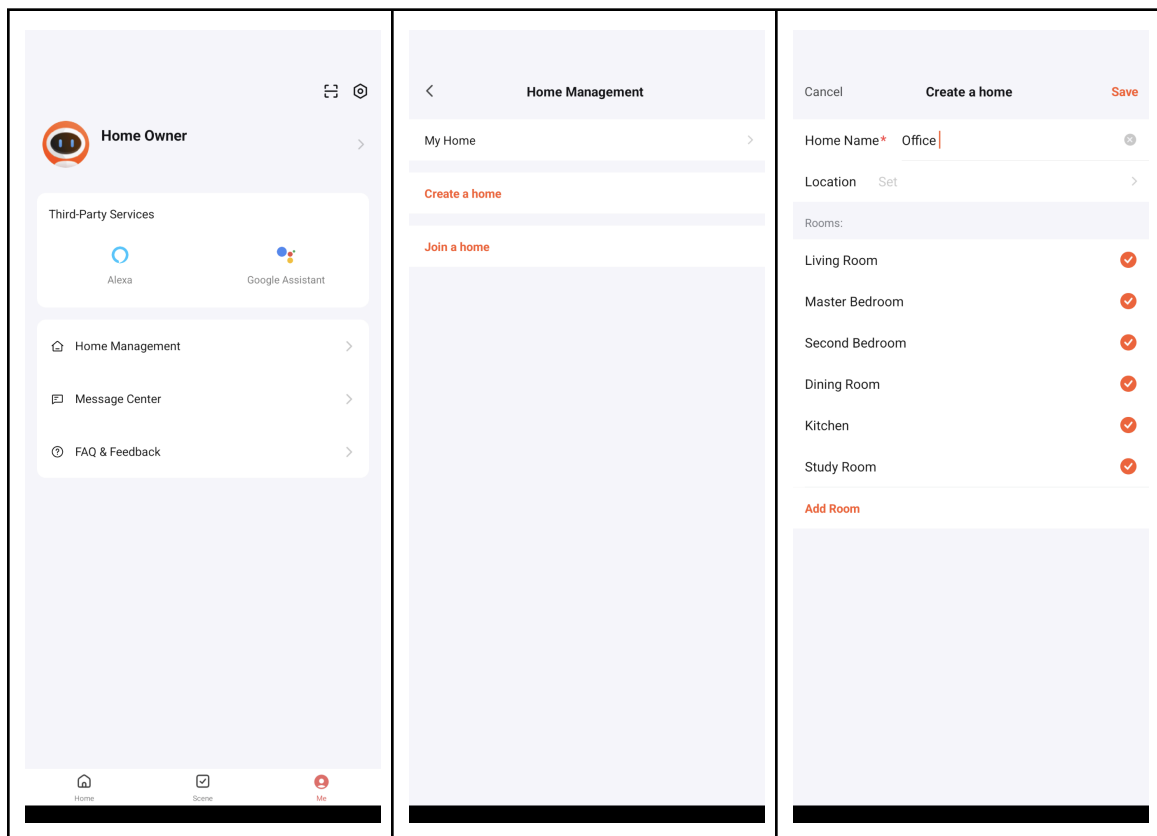

## Adding an “Admin”

1. Navigate to **Me** → **Home Management**
2. Select an **existing profile**
3. On the Home Settings screen select **Add Member**
4. **Select a contact** from the one of the phone app options displayed
5. Your invitation has now **been sent**. The person has 3 days to respond before the link expires. You can always resend the invitation.

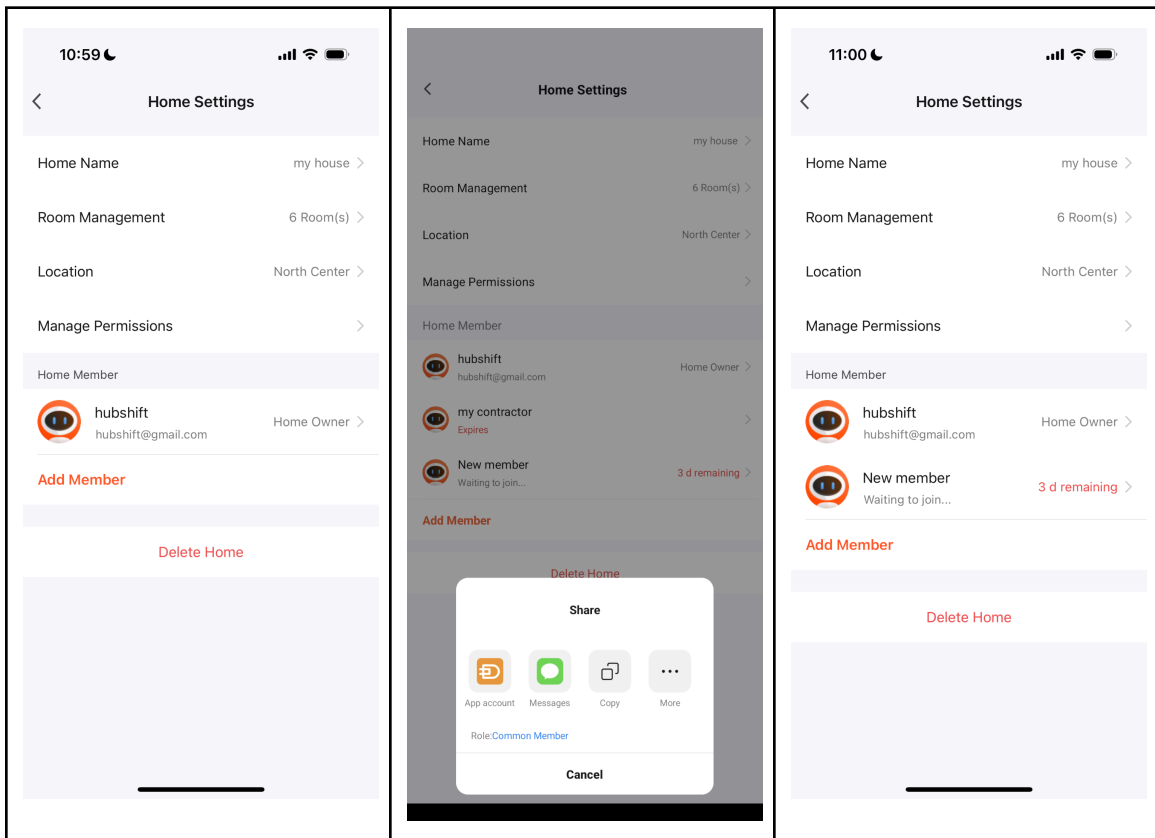

6. From the Home Settings screen select the user again to **edit their profile**
7. From the Home Member screen, **select Family Role**
8. Select **Administrator** - this user will now have administrator rights and will be able to manage your Transformers and home automation. (You can change the user role at any time)

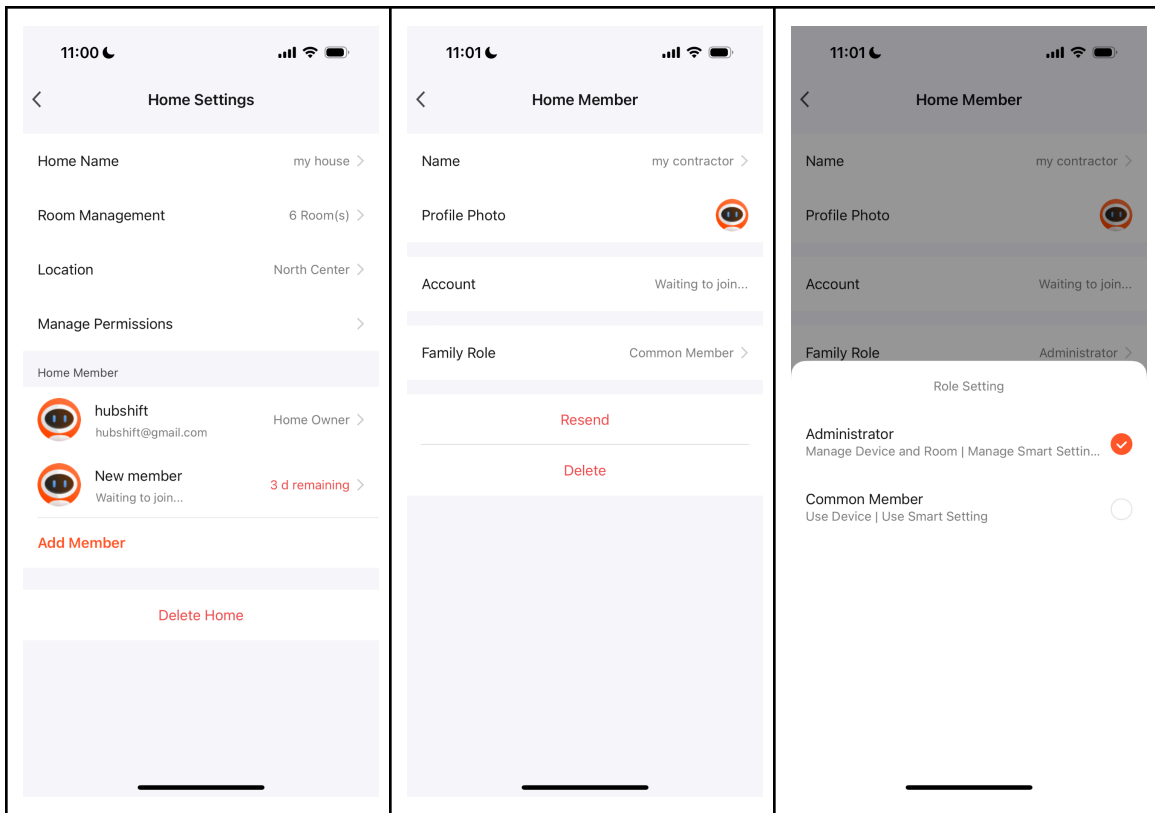

9. From the Home Member screen, you can set the user **profile name** and avatar as well.
10. From the Home Management screen, select **Manage Permissions** to set the access that is given to the Admin and Common User profiles

