



PRODUCT OVERVIEW

High performing DDDG5 Dusk To Dawn lights are ideal for providing commercial and residential properties with general perimeter and security lighting. With durable die-cast aluminum housing and advanced LED technology, they are the perfect replacement for a traditional metal halide dusk to dawn. An optional mounting arm is available for increased reach.



KEY FEATURES

CONSTRUCTION:

- Rugged die-cast aluminum housing.
- Housing is completely sealed against moisture and environmental contaminants.

FINISH:

- The exterior is protected by a rust-resistant polyester powder coat finish that provides superior resistance to weathering and corrosion.

OPTICS:

- Light engines are available in standard 4000K and 5000K configurations.
- A range of lumen options available from 6,200 to 12,400 Lumens, replaces up to 250W metal halide.

ELECTRICAL:

- Standard 120-277V input voltage.
- 1-10V dimming driver(s) as default.
- THD: $\leq 20\%$, Power Factor: $\geq 90\%$.

CONTROLS:

- Twist-lock photocell included by default - P0 120-277V.

INSTALLATION:

- Pole mount or wall mount options are available.
- Optional mounting arm is available for increased reach.

WARRANTY:

- 5 Year Limited Warranty.

LISTINGS:

- DesignLights Consortium® (DLC) Premium qualified.
- UL listed for wet locations.
- Rated for ambient operating temperature -40°F to 104°F (-40°C to 40°C).

PERFORMANCE DATA

Lumen Output

| System Watts | Voltage | 4000K(70CRI) | | 5000K(70CRI) | |
|--------------|----------|--------------|----------|--------------|----------|
| | | Lumens | Efficacy | Lumens | Efficacy |
| 45W | 120-277V | 6200lm | 138lm/W | 6200lm | 138lm/W |
| 65W | 120-277V | 8800lm | 135lm/W | 8800lm | 135lm/W |
| 90W | 120-277V | 12400lm | 138lm/W | 12400lm | 138lm/W |

Electrical Data

| Number of Drivers | Driver Current (mA) | Nominal Power (W) | Input Voltage (V) | Current (Amps) |
|-------------------|---------------------|-------------------|-------------------|----------------|
| | | 45 | 120 | 0.38 |
| 1 | 1100 | 45 | 208 | 0.22 |
| | | 45 | 240 | 0.19 |
| | | 45 | 277 | 0.16 |
| 1 | 1630 | 65 | 120 | 0.54 |
| | | 65 | 208 | 0.31 |
| | | 65 | 240 | 0.27 |
| | | 65 | 277 | 0.23 |
| 1 | 2270 | 90 | 120 | 0.75 |
| | | 90 | 208 | 0.43 |
| | | 90 | 240 | 0.38 |
| | | 90 | 277 | 0.32 |

DIMENSIONS & WEIGHT

DDDG5: 45W / 65W / 90W

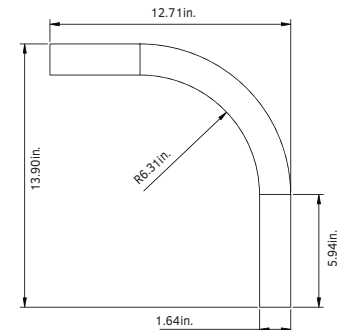
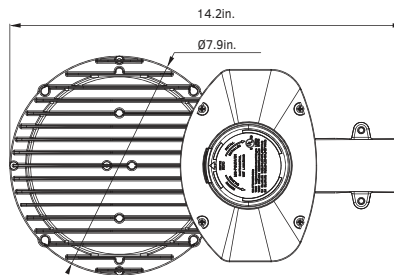
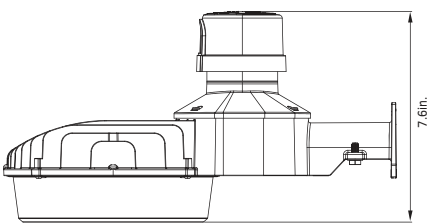

Weight
45W: 4.54 lb.
65W: 4.80 lb.
95W: 5.03 lb.

PHOTOMETRIC DISTRIBUTION

General

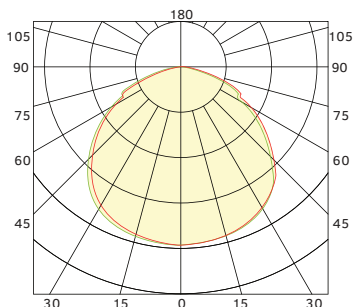

ORDERING INFORMATION

Dusk To Dawn Series DDDG5 Example: DDDG545W27V50KSGPO

| Fixture Type | Wattage | Voltage | CCT | Finish | Photocell | Internal Code |
|----------------------|--|----------------------|--------------------------------------|---|--------------------------|------------------------------|
| <input type="text"/> | <input type="text"/> | <input type="text"/> | <input type="text"/> | <input type="text"/> | <input type="text"/> | <input type="text"/> |
| DDDG5 | 45W 65W 90W | 27V 120-277V | 40K 4000K 50K 5000K | SG Silver Gray D Dark Bronze B Black W White | P0 With Photocell | Blank Alphanumeric |