



## PRODUCT OVERVIEW

This cylinder architectural series is elegant and functional. CCT selectable, the fixtures provides high flexibility for all environments. The high performance LEDs and long lasting driver also provides effective lighting all around.



## KEY FEATURES

### LISTING

- UL- and CUL-listed

### HOUSING

- Aluminium alloy body

### FINISH

UV stabilized powder coated finish for outdoor

## APPLICATIONS

	Supermarkets & Retail
	Hotels & Restaurants
	Commercial Buildings
	Schools & Colleges
	Offices & Showrooms

## CEILING MOUNT OPTIONS



3"  
DLED-3815C



4"  
DLED-4225C



6"  
DLED-6040C

## INSTALLATION METHOD

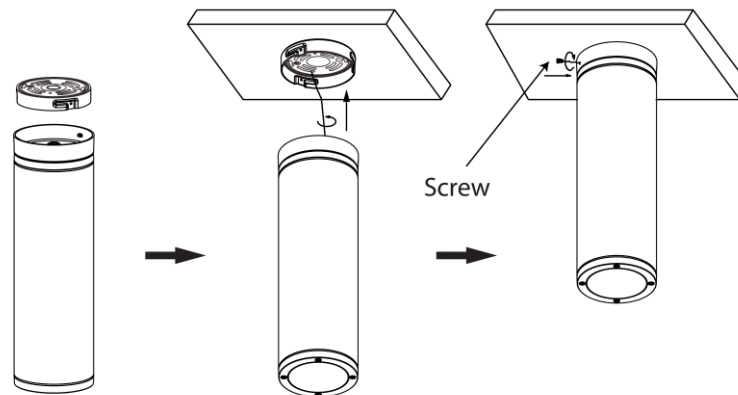

• Different LED Kelvin temperature available with 4-6 week lead time. Please call for a quote. •DISCLAIMER: This test report was produced in accordance with IES LM-79 photometric testing protocol for luminaires, using a single representative test fixture. Actual production units may vary from the values reported here by up to  $\pm 10\%$ .

## PERFORMANCE DATA

Model No.	Nominal Watts**	Lumen**	Efficacy**	Angle
DLED-3815C	13W	1670 lm**	125 lm/W**	45° / 75° *
DLED-4225C	20W	2485 lm**	120 lm/W**	*45° is only exclusive for 4225 and 6040 series
DLED-6040C	33W	4825 lm**	140 lm/W**	

\*\* Lumen and Efficacy are based on highest wattage 5000K at 75° Angle

## SPECIFICATIONS

### Example: DLED-Cylinder

Model No.	Nominal Watts**	Input Voltage	CRI	Color Temp*	Angle	Optional Accessories	Finish	Starting Temp
DLED-3815C	13=13W	UNV=120-277V	8=80+	TX =	45°	R = 4ft (4x12") connectable stems and base for Pendant Mount	WH=White	-40°C
DLED-4225C	20=20W			3000K	75°		BK=Black	
DLED-6040C	33=33W			4000K 5000K	GY=Gray			

45° is only exclusive for 4225 and 6040 series



• Different LED Kelvin temperature available with 4-6 week lead time. Please call for a quote. \*\*DISCLAIMER: This test report was produced in accordance with IES LM-79 photometric testing protocol for luminaires, using a single representative test fixture. Actual production units may vary from the values reported here by up to ±10%.

## DIMENSIONS

### CEILING MOUNT

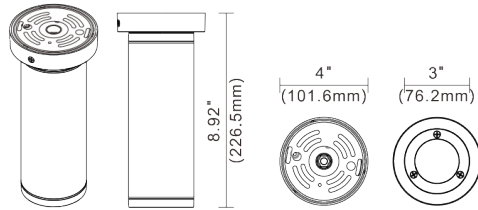

DLED-3815C  
3"

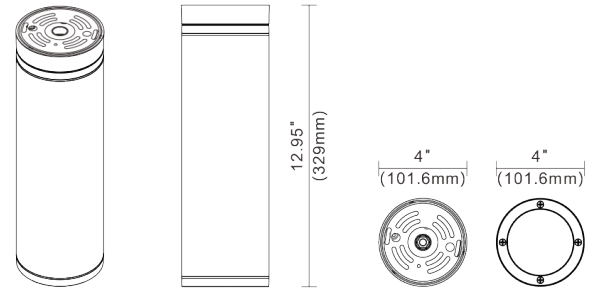

DLED-4225C  
4"

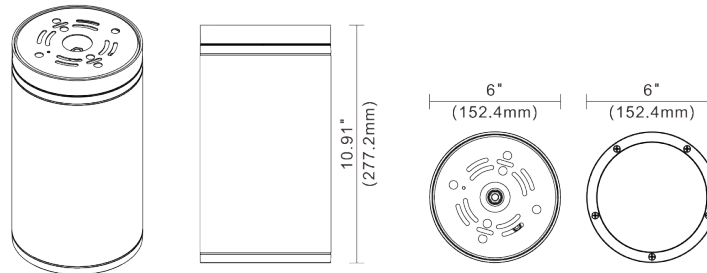

DLED-6040C  
6"



• Different LED Kelvin temperature available with 4-6 week lead time. Please call for a quote. •DISCLAIMER: This test report was produced in accordance with IES LM-79 photometric testing protocol for luminaires, using a single representative test fixture. Actual production units may vary from the values reported here by up to ±10%.